



## **ATD-81060 X-Large Blow Molded Creeper Owner's Manual**



### **Features:**

- Unrestricted arm movement
- (2) molded-in trays
- (6) 4" x 1-1/2" swivel casters
- Comfortable headrest

### **Specifications:**

- Overall size: 45" L x 6" H x 22-1/2" W
- Material: High density polyethylene (HDPE)
- Capacity: 400 lbs.

ASSEMBLY INSTRUCTIONS

Insert Bolts into Caster Base

Place two bolts (#4) through the square holes in the caster base, as shown.  
Ensure the square shoulder of each bolt fits securely into the square hole to prevent rotation during assembly.

Attach Caster to Creeper Body

Position the caster onto the plastic body of the creeper (#1), aligning the bolts with the corresponding holes.  
Push the bolts fully through the creeper body.

Install Sleeves

Slide a sleeve (#6) over each bolt protruding through the top side of the creeper body. The sleeves should fit snugly and recess slightly into the plastic body.

Secure with Nuts

Thread a nut (#5) onto each bolt and tighten securely.

Repeat

Repeat this procedure for the remaining five casters.

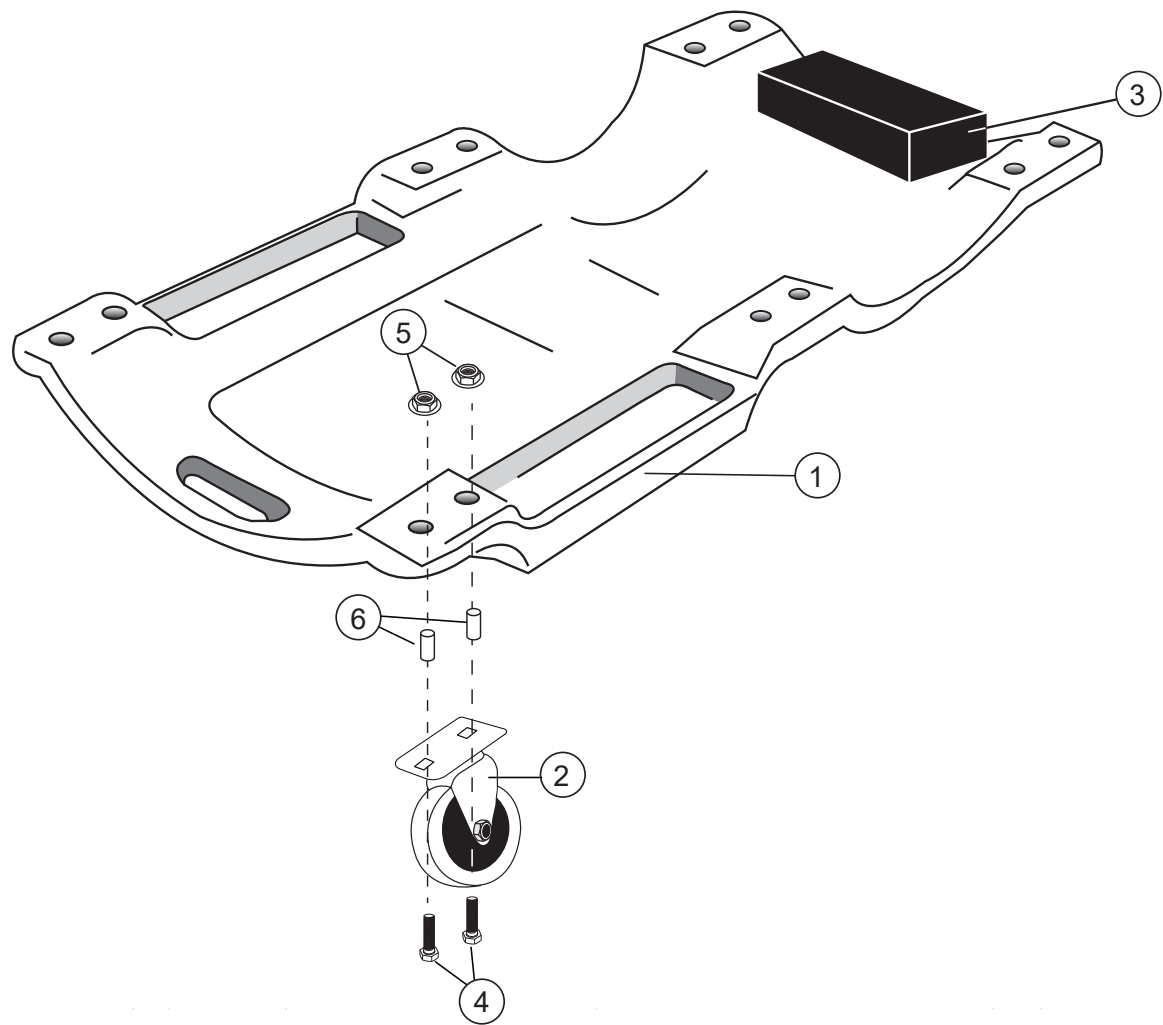

ITEM#	ORDERING PART#	PART DESCRIPTION
1	PRT81060-01	MAIN CREEPER BODY
2	ATD-81035	CASTER
3	PRT81060-03	HEADREST
4, 5, 6	PRT81060-H	HARDWARE PACKAGE*

\*Hardware Package Includes 12 bolts (4), 12 shoulder nuts (5) and 12 sleeves (6)



**THIS WARRANTY AND CONFIRMED RECEIPT(S) SHOULD BE RETAINED BY THE CUSTOMER AT ALL TIMES**

PURCHASED FROM: \_\_\_\_\_

DATE PURCHASED: \_\_\_\_\_

INVOICE/RECEIPT NUMBER: \_\_\_\_\_

Your ATD-81060 is warranted for a period of 12 months from the original purchase date.

For a period of one (1) year from your purchase date, ATD Tools, Inc. will repair or replace (at its option) without charge, your ATD product if it was purchased new and the product has failed due to a defect in material or workmanship which you experienced during normal use of the product. This limited warranty is your exclusive remedy.

To access the benefits of this warranty, contact your supplier, or point of sale directly. You may be advised to return the product under warranty, freight prepaid, to your supplier for warranty determination.

If this ATD product is altered, abused, misused, modified, or undergoes service by an unauthorized technician, your warranty will be void. We are not responsible for damage to ornamental designs you place on this ATD product and such ornamentation should not cover any warnings or instructions or they may void the warranty. This warranty does not cover scratches, superficial dents, and other abrasions to the paint finish that occur under normal use. It also does not cover normal wear items such as but not limited to brushes, batteries, drill bits, drill chucks, pads or blades.

Subject to the law in your state:

- (1) Your sole and exclusive remedy is repair or replacement of the defective product as described above.
- (2) ATD is not liable for any incidental damages, including but not limited to, lost profits and unforeseeable consequences.
- (3) The repair and replacement of this product under the express limited warranty described above is your exclusive remedy and is provided in lieu of all other warranties, express or implied. All other warranties, including implied warranties and warranties of merchantability or fitness for a particular purpose are disclaimed and, if disclaimer is prohibited, these warranties are limited to one year from your date of purchase of this product.

Some states' laws do not allow limited durations on certain implied warranties and some states' laws do not allow limitations on incidental or consequential damages. You should consult the law in your state to determine how your rights may vary.

[Affix receipt or invoice here for safe keeping]