



# **Engine Stand**

## **Operating Instructions & Parts Manual**

*Model Number*  
**ATD-7482**

*Capacity*  
**1250 lbs.**

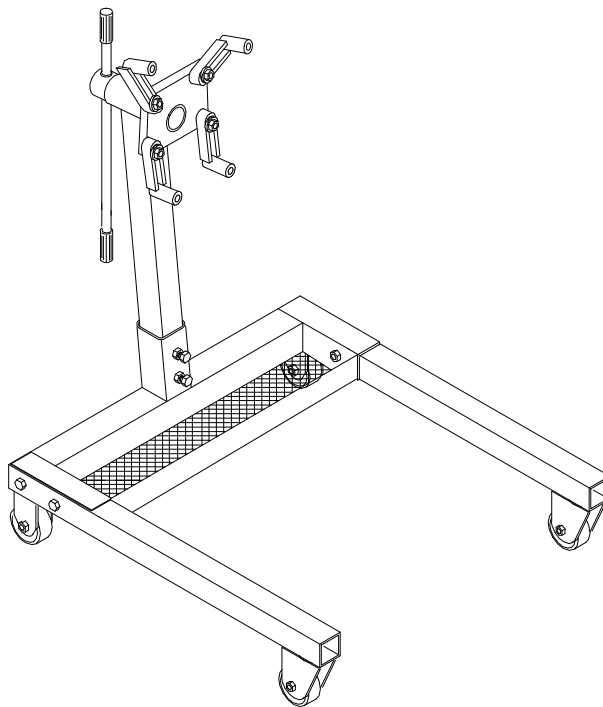

### **⚠ WARNING ⚠**

**WARNING:** This product may contain chemicals, including lead, known to the State of California to cause cancer, birth defects or other reproductive harm. *Wash hands after handling.*

Made in China to ATD Tools, Inc. Specifications  
Visit us at [www.atdtools.com](http://www.atdtools.com)

Printed In China  
ATD7482\_rev\_0417

**Save these instructions.** For your safety, read and understand the information contained within. The owner and operator shall have an understanding of this product and safe operating procedures before attempting to use this product. Instructions and Safety information shall be conveyed in the operators native language before use of this product is authorized. Make certain that the operator thoroughly understands the inherent dangers associated with the use and misuse of the product. If any doubt exists as to the safe and proper use of this product as outlined in this factory authorized manual, remove from service until which time it is clear. **Inspect before each use.** Do not use if broken, bent, cracked or otherwise damaged parts are noted. If the stand has been or suspected to have been subjected to a shock load, discontinue use until checked out by an authorized factory service center. Owners and operators of this equipment shall be aware that the use and subsequent repair of this equipment may require special training and knowledge. It is recommended that an annual inspection be done by qualified personnel and that any missing or damaged parts, decals, warning / safety labels or signs be replaced with factory authorized replacement parts only. Any stand that appears to be damaged in any way, is worn or operated abnormally should be removed from service immediately until such time as repairs can be made.

### PRODUCT DESCRIPTION

ATD Tools Engine Stands are designed to safely support rated capacity engines. Welded steel tube construction, heavy gauge steel head plates and mounting arms along with compliance with the latest **ASME / ANSI - PALD** standards ensure safety, strength and stability. Each model comes with a head plate lock which helps prevents inadvertent rotation of engine. Model # ATD-7482 base is of U shape construction. The U shape allows even greater stability of loads up to 1250 lbs.

### SPECIFICATIONS

Model	Capacity	Base Size (L x W)	Overall Height	Head Plate	Head Plate Expansion	Wheel Diameter	Handle Length	Weight
ATD-7482	1,250 lbs.	33-3/8" x 33-7/8"	42-3/4"	7-1/2" x 6-1/2" x 5/8"	7-1/2" - 10-1/2"	3-1/2"	20-1/4"	83.25 lbs.

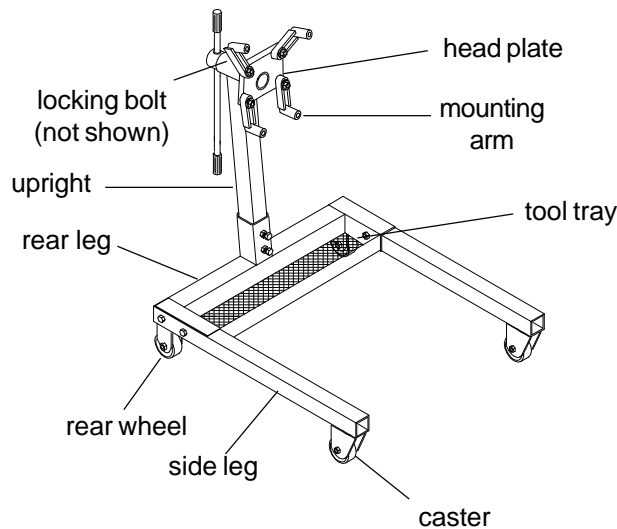

Figure 2 - Model ATD-7482 Engine Stand components

### BEFORE USE

1. Inspect stands before each use. Do not use if bent, broken or cracked components are noted. Ensure that casters / wheels and head plate rotate freely. Check for and tighten any loose assemblies.
2. Verify that the product and the application are compatible.
3. Before using this product, read the owner's manual completely and familiarize yourself thoroughly with the product and the hazards associated with its improper use.

**⚠ WARNING**

FAMILIARIZE YOURSELF THOROUGHLY WITH PRODUCT. READ AND UNDERSTAND OWNER'S MANUAL BEFORE USE. USE ON HARD LEVEL SURFACES CAPABLE OF SUSTAINING RATED CAPACITY LOADS. DO NOT OVERLOAD BEYOND RATED CAPACITY. LOCK ROTATING DEVICE BEFORE APPLYING LOAD. *MOVE LOADED STAND, CAREFULLY, AND ONLY OVER LEVEL, SMOOTH SURFACES. ROTATE ENGINE SLOWLY, CAREFULLY.* TAKE EVERY NECESSARY PRECAUTION TO ENSURE YOUR SAFETY. OFF CENTER LOADS MAY CAUSE THE STAND TO TIP OR FLIP VIOLENTLY. DO NOT MODIFY STAND OR SUBSTITUTE HARDWARE. NEVER USE THIS PRODUCT FOR ANY PURPOSE OTHER THAN THAT FOR WHICH IT IS DESIGNED. NEVER ADD EXTENSION DEVICE TO ADAPTER BARS. FAILURE TO HEED THIS WARNING MAY RESULT IN SEVERE INJURY AND/OR PROPERTY DAMAGE.

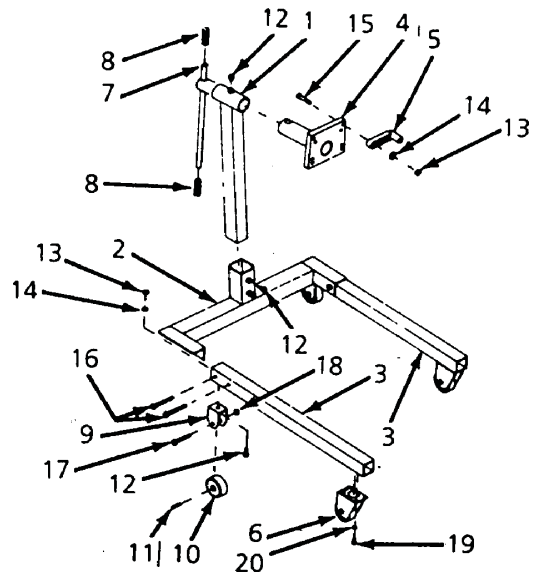

Figure 4 - Assembly Illustration for model ATD-7482

**Model: ATD-7482 (see Figure 4, tool tray not shown)**

1. Attach wheel bracket ( Ref. No. 9 ) to side leg ( Ref. No. 3 ) with 1/2" x 1" lg. bolt (Ref. No. 12).
2. Insert bushing (Ref. No. 11) into wheel (Ref. No. 10).
3. Attach wheel to bracket with 3/8" x 2 1/2" lg. bolt (Ref. No. 17) and nut (Ref. No. 18).
4. Attach caster (Ref. No. 6) to side leg using 5/16" x 5/8" lg. bolt (Ref. No. 19) and 5/16" spring washer (Ref. No. 20).
5. Attach rear leg (Ref. No. 2) to side legs (Ref. No. 3) with two 1/2" x 3" lg. bolt (Ref. No. 16) each.
6. Attach upright (Ref. No.1) to rear leg using 1/2" x 1" lg. bolt (Ref. No. 12).
7. Place head assembly (Ref. No. 4) into collar of upright. Insert 1/2" x 1" lg. bolt (Ref. No. 12) to fasten head assembly.
8. Insert handle (Ref. No. 7) into hole of head assembly.
9. Place handle grip (Ref. No. 8) on each end of handle.

## OPERATION

1. Ensure application is compatible with product.
2. Align engine with stand, then adjust mounting arms to match bell housing mounting bolt holes. **Rotational lock must be secure before applying load.**
3. Carefully secure engine so that load is centered on stand. Secure with suitable high strength stud bolts and flat washers. **Ensure threads are compatible with your engine.** Use flat washers on both sides of head plate.
4. To rotate engine, loosen bolt. Use handle to rotate, then secure with rotational locking device.
5. Check to ensure stand is secure before working on or around stand. **NEVER WORK UNDER LOADED STAND.**

**NOTE: DO NOT MOVE LOADED STAND OFF HARD SMOOTH, LEVEL SURFACE!**

## MAINTENANCE

Periodically inspect each stand. Ensure all parts move freely. Apply very light coating of grease to head plate collar. If rust appears, sand affected area and cover with suitable utility paint.



## ONE YEAR LIMITED WARRANTY

For a period of one (1) year from date of purchase, **ATD Tools, Inc.** will repair or replace, at its option, without charge, any of its products which fails due to a defect in material or workmanship, or which fails to conform to any implied warranty not excluded hereby.

Performance of any obligation under this warranty may be obtained by contacting your distributor or point of sale for further instructions. Please retain your proof of purchase, as it will be needed for any claim.

Except where such limitations and exclusions are specifically prohibited by applicable law, (1) the CONSUMER'S SOLE AND EXCLUSIVE REMEDY SHALL BE THE REPAIR OR REPLACEMENT OF DEFECTIVE PRODUCTS AS DESCRIBED ABOVE, and (2) **ATD Tools, Inc.** SHALL NOT BE LIABLE FOR ANY CONSEQUENTIAL OR INCIDENTAL DAMAGE OR LOSS WHATSOEVER, and (3) THE DURATION OF ANY AND ALL EXPRESSED AND IMPLIED WARRANTIES, INCLUDING WITHOUT LIMITATION, ANY WARRANTIES OF MERCHANTABILITY AND FITNESS FOR A PARTICULAR PURPOSE, IS LIMITED TO A PERIOD OF ONE (1) YEAR FROM DATE OF PURCHASE.

Some states do not allow limitations on how long an implied warranty lasts, so the above limitation may not apply to you. Some states do not allow the exclusion or limitation of incidental or consequential damages, so the above limitation or exclusion may not apply to you. This warranty gives you specific legal rights, and you may also have other rights which vary from state to state.



## REPLACEMENT PARTS

Available Parts: Please refer to the Parts drawing when ordering parts. Not all components of the product are replacement items, but are illustrated as a convenient reference of location and position in the assembly sequence. When ordering parts, give model number, part number and description below. Call your distributor for current pricing.

Model ATD-7482

<u>Parts No.</u>	<u>Description</u>	<u>Quantity</u>
1	head plate	1
2	mounting arm assembly	4
3	caster assembly	2
4	rear wheel assembly	2
5	handle assembly	1
999	hardware kit	all nuts and bolts

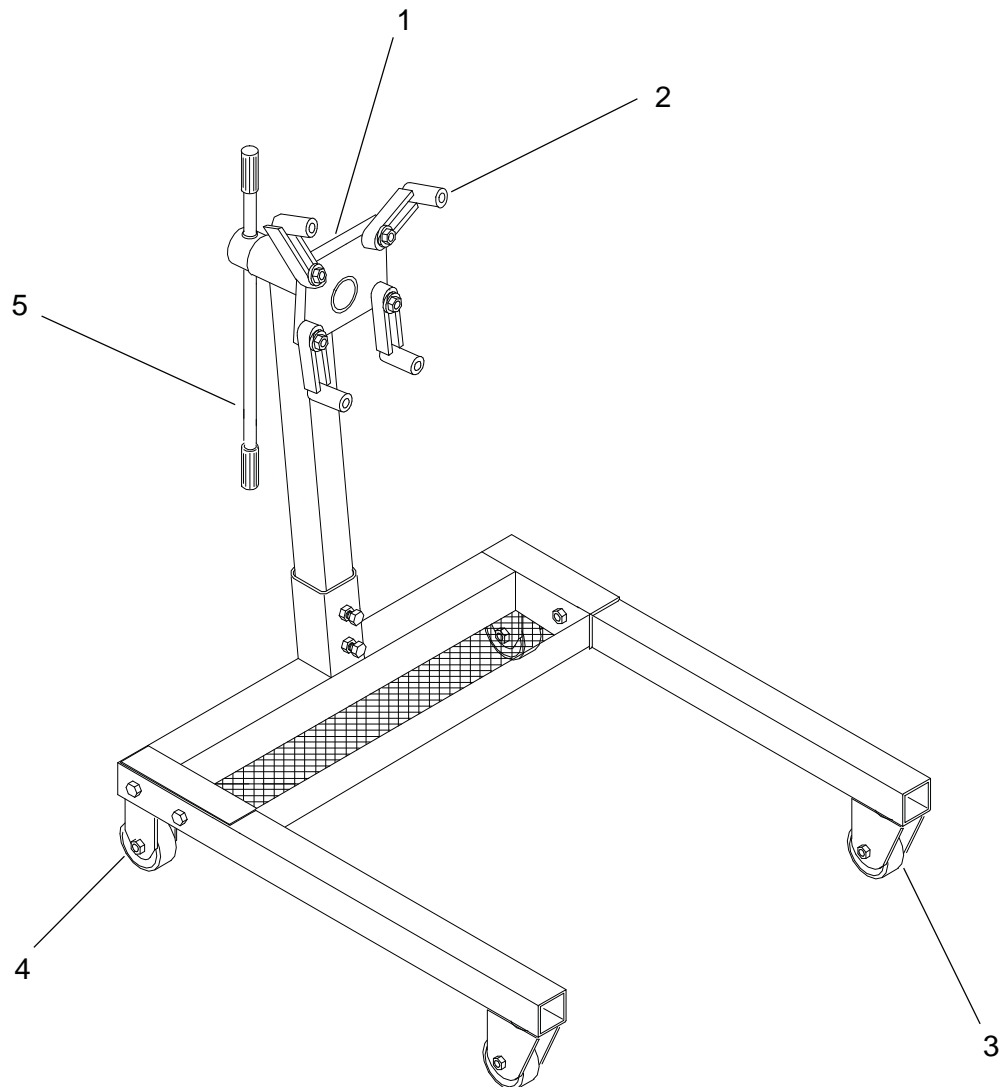

Figure 6 - Replacement Parts Illustration for model ATD-7482



---

---

---

---

---

---

---

---

---

---

---

---

---

---

---

---

---

---

---

---

---

---

---

---

---

---

---

---

---

---

---

