



**ATD-7474**  
**Mechanical Vehicle Positioning Jack**  
**Storage Rack for ATD-7475**  
**Owner's Manual**



Shown with ATD-7475 Vehicle Positions Jacks  
(Sold seperately)

**Features:**

- Stores up to (4) ATD-7475 jacks for easy access
- Takes up less shop floor space
- (4) swivel casters let you move rack where needed
- Sturdy steel construction

**Specifications:**

- Capacity: Four (4) ATD-7475 vehicle position jacks
- Four (4) 5" swivel casters
- Dimensions: 32-1/4" W x 24-3/4" D x 10-1/8" H

## Operation:

The owner and/or operator should study the product instructions and retain them for future reference. The owner and/or operator should have an understanding of the product, its operating characteristics, and safety operating instructions before operating the equipment. Safety information should be emphasized and understood. The warnings and cautions discussed in this instruction manual cannot cover all possible conditions and situations that may occur. It must be understood by the operator that common sense and caution are factors which cannot be built into this product, but must be supplied by the operator.

## Safety:

**Failure to heed these safety warnings may result in personal injury and/or property damage.**

 **WARNING:** Study, understand and follow all instructions before operating this device.

 **WARNING:** This unit is designed for ATD-7475 Vehicle Positioning Jacks only.

 **WARNING: DO NOT** overload unit beyond the load rating of 4 pieces of ATD-7475 (135 lbs / 60 Kg)

 **WARNING: DO NOT** operate unit on inclined surfaces. Unit must be used on level surface only.

 **WARNING: DO NOT** attempt to push jack rack over obstacles. They are designed to be used on level surfaces only.

 **WARNING:** No alterations should be made to this product.

## Damaged Equipment:

Any equipment that appears to be damaged in any way or is found to be worn or operating abnormally should be **REMOVED FROM SERVICE UNTIL REPAIRED**. It is recommended that necessary repairs be made by a specialized repair facility.

## Inspection:

- Visual inspection should be made before each use of this equipment by checking for abnormal conditions, such as cracked welds, damaged or missing parts.
- Each piece of equipment should be inspected immediately if the device is believed to have been subjected to an abnormal load or shock. It is recommended that the inspection be made by a specialized repair facility.
- Owners and/or operators should be aware that repair of this equipment may require specialized knowledge.

## Assembly Instructions:

1. Assemble left and right frame to center frame rack using 2 bolts (#4) and nuts (#8). Tighten all fasteners, taking care not to over-tighten.
2. Install casters to left and right frames with provided caster nuts (#1). Tighten all fasteners, taking care not to over-tighten.

## REPLACEMENT PARTS

Not all components of this product are replacement items, but are illustrated as a convenient reference for position in the assembly sequence. When ordering parts, give model number, part number and description. Call your distributor for current pricing:

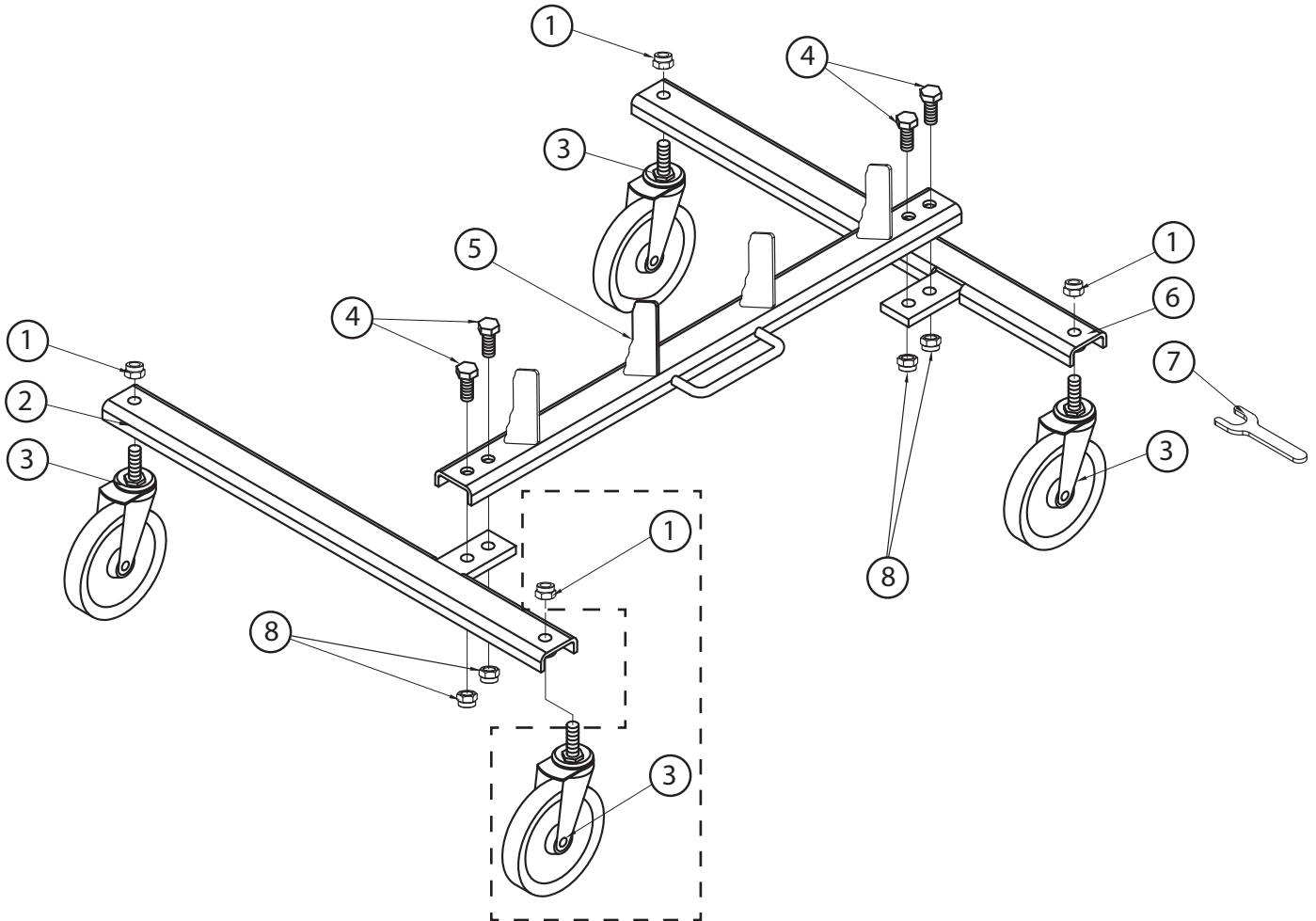

ITEM#	ORDERING PART#	PART DESCRIPTION
1	N/A	CASTER NUT
2	N/A	FRAME LEFT
3	PRT7474-03	CASTER W/NUT
4	N/A	BOLT, M12 x 30
5	N/A	FRAME CENTER
6	N/A	FRAME RIGHT
7	N/A	WRENCH
8	N/A	NUT, M12



# ATD<sup>®</sup>

## WARRANTY

1 YEAR LIMITED WARRANTY

**THIS WARRANTY AND CONFIRMED RECEIPT(S) SHOULD BE RETAINED BY THE CUSTOMER AT ALL TIMES**

PURCHASED FROM: \_\_\_\_\_

DATE PURCHASED: \_\_\_\_\_

INVOICE/RECEIPT NUMBER: \_\_\_\_\_

Your ATD-7474 is warranted for a period of 12 months from the original purchase date.

For a period of one (1) year from your purchase date, ATD Tools, Inc. will repair or replace (at its option) without charge, your ATD product if it was purchased new and the product has failed due to a defect in material or workmanship which you experienced during normal use of the product. This limited warranty is your exclusive remedy.

To access the benefits of this warranty, contact your supplier, or point of sale directly. You may be advised to return the product under warranty, freight prepaid, to your supplier for warranty determination.

If this ATD product is altered, abused, misused, modified, or undergoes service by an unauthorized technician, your warranty will be void. We are not responsible for damage to ornamental designs you place on this ATD product and such ornamentation should not cover any warnings or instructions or they may void the warranty. This warranty does not cover scratches, superficial dents, and other abrasions to the paint finish that occur under normal use. It also does not cover normal wear items such as but not limited to brushes, batteries, drill bits, drill chucks, pads or blades.

Subject to the law in your state:

- (1) Your sole and exclusive remedy is repair or replacement of the defective product as described above.
- (2) ATD is not liable for any incidental damages, including but not limited to, lost profits and unforeseeable consequences.
- (3) The repair and replacement of this product under the express limited warranty described above is your exclusive remedy and is provided in lieu of all other warranties, express or implied. All other warranties, including implied warranties and warranties of merchantability or fitness for a particular purpose are disclaimed and, if disclaimer is prohibited, these warranties are limited to one year from your date of purchase of this product.

Some states' laws do not allow limited durations on certain implied warranties and some states' laws do not allow limitations on incidental or consequential damages. You should consult the law in your state to determine how your rights may vary.

[Affix receipt or invoice here for safe keeping]