

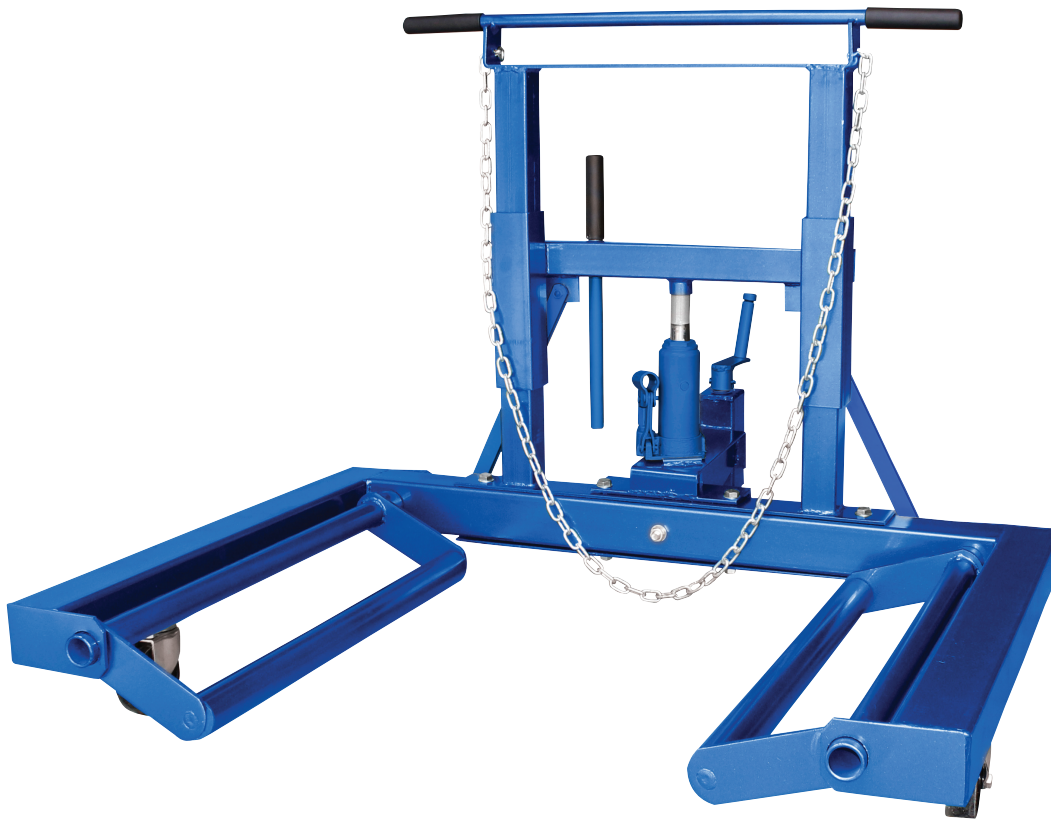

# ATD-7227B

## 3/4 Ton Hydraulic Wheel Dolly Owner's Manual



### Features:

- For the removal, installation and transportation of single, dual and duplex tires and wheel assemblies
- Lift arms can be adjusted to handle different wheel combinations
- Leveling screw adjusts tilt angle for precise alignment
- Suitable for tire diameters of 23-5/8" - 60"
- (3) swivel casters (1 locking) allow for easy movement and positioning
- Safety chain for securing loads
- Meets or exceeds ASME/PASE 2019 standards

### Specifications:

- Capacity: 3/4 Ton / 1500 lbs.
- Lifting Range: 3-3/8" - 11-1/4"
- Tilt Range: -1.2° - 4.8°
- Lifting Arm Dimensions: 25-1/2" D x 32-1/2" W
- Jack Size: 41-3/8" L x 42-15/16" W x 34-5/16" H
- Weight: 178 lbs.

## **Important: Read ALL instructions before use**

Before using this product, be sure to read all content within this manual, ensuring that you understand the operating procedures, maintenance requirements and all safety warnings.

The owner and/or operator should have an understanding of the product, its operating characteristics and safety operating instructions before operating this device. Safety information should be emphasized and understood. If the operator is not fluent in English, the product and safety instructions should be read to and discussed with the operator in the operator's native language by the purchaser/owner or his designee, making sure that the operator comprehends their contents.

---

## **⚠️ WARNING** Actions to prevent dangerous situations

- Study, understand, and follow all instructions before operating this device.
- Do not exceed the rated capacity stated.
- Use only on hard level surfaces.
- Before moving, lower the load to the lowest possible point.
- Apply the load as close to the vertical position of the lifting member as possible.
- Before moving the load, ensure that the load is centered and secured with a load-restraint device.
- No alterations should be made to this product.
- Failure to heed these warnings may result in serious personal injury / property damage.

## **Inspection**

- This device should be inspected immediately if the device is believed to have been subjected to an abnormal load or shock. It is recommended that this inspection be made by a manufacturer's or suppliers authorized repair facility.
- Owners and/or operators should be aware that repair of this equipment may require specialized knowledge and facilities. It is recommended that an annual inspection of the product be made by a manufacturer's or supplier's authorized repair facility and that any defective parts, decals or safety labels or signs be replaced with manufacturer's or supplier's specified parts.

## **Damaged equipment and add-ons**

Any dolly that appears to be damaged, is found to be worn or operates abnormally in any way should be **removed from service until proper repair can be done on the product.**

### **Alterations**

Because of potential hazards associated with this type of equipment, no alterations should be made to the product.

### **Attachments and Adapters**

Only attachments and/or adapters (if available) supplied by the manufacturer should be used.

## **Setup**

- Prior to each use, visual inspection should be made to the device by checking for abnormal conditions such as cracked welds, damaged, loose or missing parts.
- Assemble the tire dolly as shown in the assembly section.

## Assembly

- Attach the swivel caster (#16) to the base frame (#1) using (4) M8 x 16 hex bolts (#17) and (4) M8 hex locknuts (#15) NOTE: When attaching the swivel caster assembly, insert the bolts so that when the stand is upright, the hex locknuts will be facing upwards.
- Assemble the caster part (#19) to the Caster Carrier (#11), Separate Crank Handle (#20) by taking out the B Pin (#23) from Roll Pin (#22). Put Slide Weldment (#21) into the Carrier (#11), assemble and lock the Crank Handle (#20) with Roll Pin (#22) and B pin (#23).
- Insert the upright assembly (#2) onto the frame (#1) using M12 x 110mm hex bolts (#12), (3) M12 nuts (#13) and (3) M12 flat washers (#14).
- Assemble the support braces (#6) to the frame (#1) and upright assembly (#2) by attaching the support braces to the bracket (#7) of the frame and upright assembly (#2) by using (4) M8x30mm bolts (#8), flat washers, lock washers & nuts (#9, #5, #4). NOTE: Make sure the support braces are located on each side of the frame bracket and the assembly bracket.
- Insert the assembled Caster Carrier (#11) and Caster Assembly Part (#19) onto the frame (#1) using (2) M12 x 100mm hex bolts (#12), (2) M12 nuts (#13) and (2) M12 flat washers (#14).
- Place the bottle jack (#3) onto the upright assembly (#2). Refer to diagram. NOTE: Screw out the bottle jack extension screw so that the upright assembly will rest on the bottle jack.
- Attach the safety chain (#10) by putting the links into the slots on the upright assembly (#2)

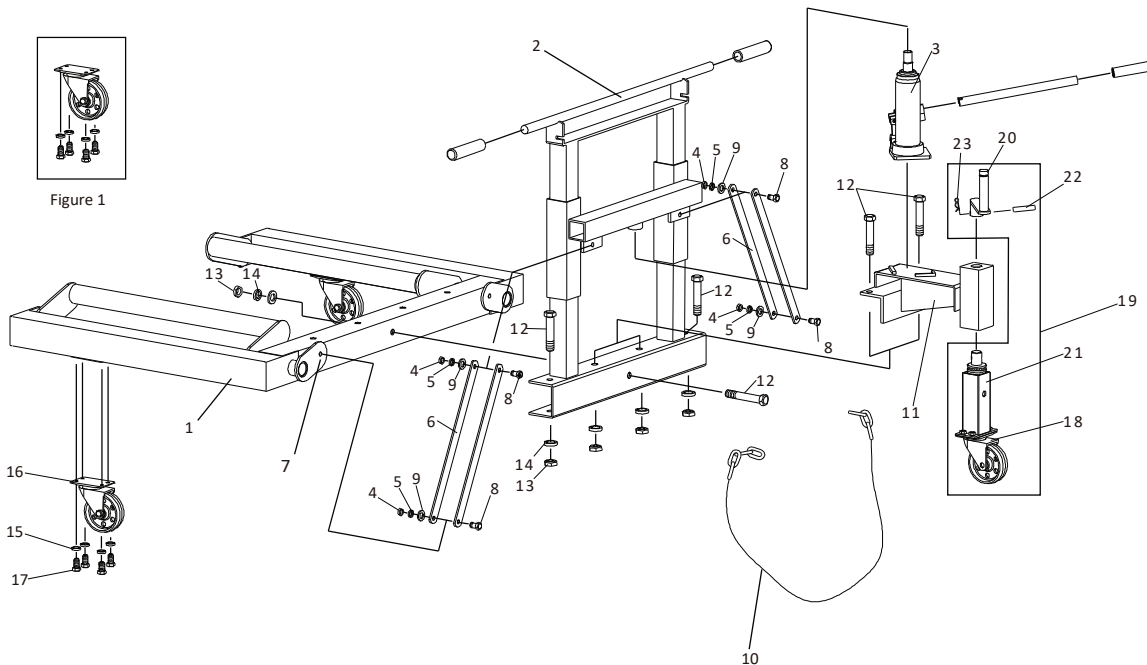

## Operation

### Supporting a Load

- Raise the vehicle so that the wheels that are to be removed are clear of the ground.
- Ensure the vehicle is properly supported and that the wheels not being removed are properly blocked. Ensure that the emergency brake is activated.
- Ensure that the wheels are straight in order to make the removal easier.
- Lower the dollies lifting arms by turning the release valve fully counter clockwise and position the dolly under the wheel that is to be removed.
- Loop the safety chain around the wheel being removed and make sure they the chain is snug but not over tightened before attaching it to the connecting points.
- Raise the dolly lifting arms by turning the release valve clockwise on the hydraulic unit. Pump the handle of the hydraulic unit until the lift arms are supporting the weight of the tire.
- Once supported, you can remove the tire from the vehicle.

## Maintenance

Inspect dolly before use. Ensure all parts move freely. If rust appears, sand away the rust area and cover with appropriate utility paint.

## REPLACEMENT PARTS

Not all components of this product are replacement items, but are illustrated as a convenient reference for position in the assembly sequence. When ordering parts, give model number, part number and description. Call your distributor for current pricing:

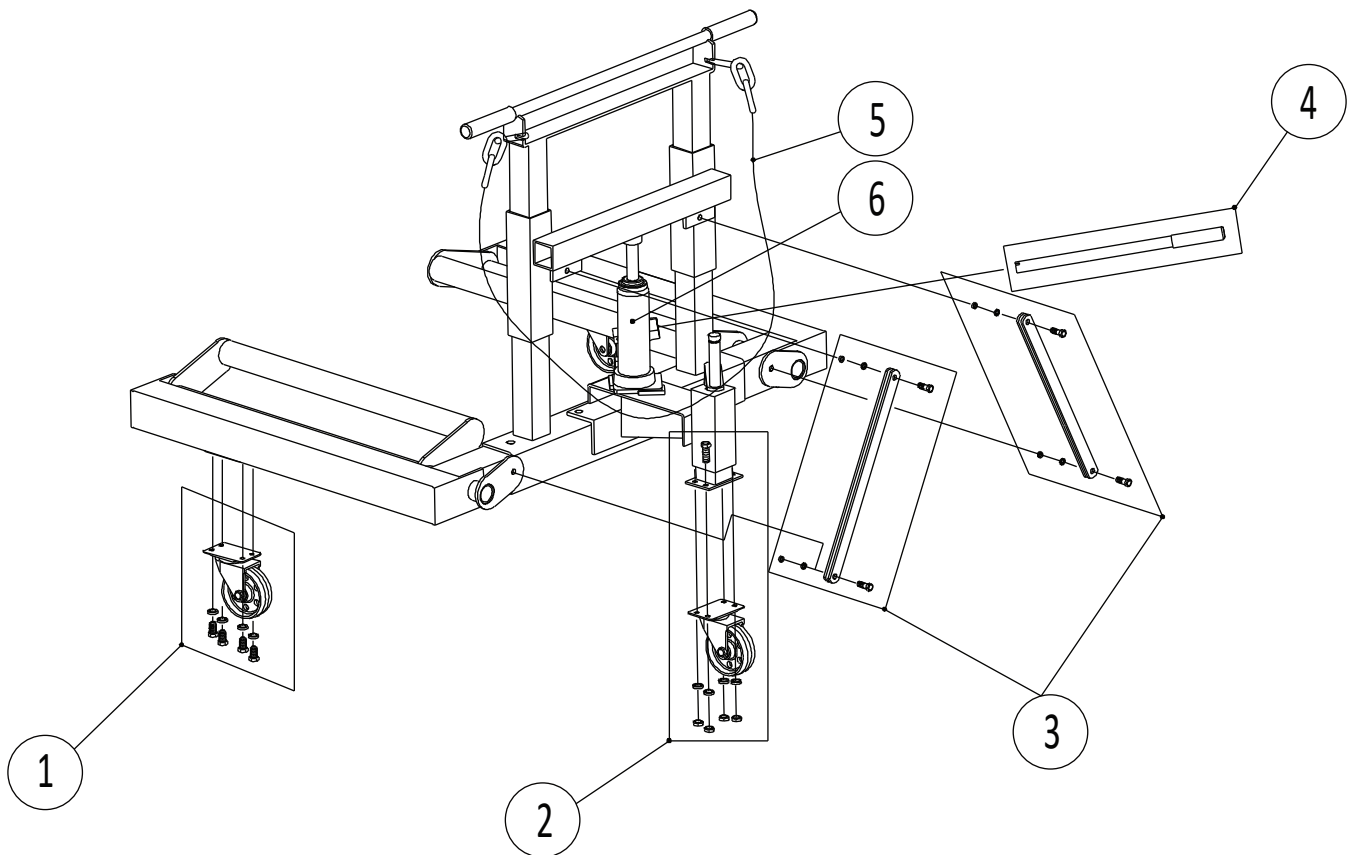

Item Number	Part Number	Description	Qty
1	1500LC-100	3-1/2" Caster Assembly	2
2	1500LC-200	3" Rear Caster Assembly	1
3	1500LC-300	Support Braces	2
4	1500LC-400	Handle Assembly	1
5	1500LC-3	Safety Chain	1
6	1500LC.7	Bottle Jack	1

\* Items not identified by part number are not available for replacement

ATD Tools, Inc. • 160 Enterprise Drive • Wentzville, MO 63385  
Tool Free Service Number • 1-844-364-9922



# NOTES:

---

---

---

---

---

---

---

---

---

---

---

---

---

---

---

---

---

---

---

---

---

---

---

---

---

---



# ATD<sup>®</sup>

## WARRANTY

1 YEAR LIMITED WARRANTY

**THIS WARRANTY AND CONFIRMED RECEIPT(S) SHOULD BE RETAINED BY THE CUSTOMER AT ALL TIMES**

PURCHASED FROM: \_\_\_\_\_

DATE PURCHASED: \_\_\_\_\_

INVOICE/RECEIPT NUMBER: \_\_\_\_\_

Your ATD-7227B is warranted for a period of 12 months from the original purchase date.

For a period of one (1) year from your purchase date, ATD Tools, Inc. will repair or replace (at its option) without charge, your ATD product if it was purchased new and the product has failed due to a defect in material or workmanship which you experienced during normal use of the product. This limited warranty is your exclusive remedy.

To access the benefits of this warranty, contact your supplier, or point of sale directly. You may be advised to return the product under warranty, freight prepaid, to your supplier for warranty determination.

If this ATD product is altered, abused, misused, modified, or undergoes service by an unauthorized technician, your warranty will be void. We are not responsible for damage to ornamental designs you place on this ATD product and such ornamentation should not cover any warnings or instructions or they may void the warranty. This warranty does not cover scratches, superficial dents, and other abrasions to the paint finish that occur under normal use. It also does not cover normal wear items such as but not limited to brushes, batteries, drill bits, drill chucks, pads or blades.

Subject to the law in your state:

- (1) Your sole and exclusive remedy is repair or replacement of the defective product as described above.
- (2) ATD is not liable for any incidental damages, including but not limited to, lost profits and unforeseeable consequences.
- (3) The repair and replacement of this product under the express limited warranty described above is your exclusive remedy and is provided in lieu of all other warranties, express or implied. All other warranties, including implied warranties and warranties of merchantability or fitness for a particular purpose are disclaimed and, if disclaimer is prohibited, these warranties are limited to one year from your date of purchase of this product.

Some states' laws do not allow limited durations on certain implied warranties and some states' laws do not allow limitations on incidental or consequential damages. You should consult the law in your state to determine how your rights may vary.

[Affix receipt or invoice here for safe keeping]