



## ATD-7037 & ATD-7038 Medium and Large Heavy-Duty Plastic Utility Carts Owner's Manual



ATD-7037



ATD-7038

### ATD-7037 Features:

- Heavy duty polypropylene material
- Molded handle with storage compartments and towel bar
- 3" deep trays
- (4) 5" heavy-duty non-marring casters (2-360° swivel)

### ATD-7037 Specifications:

- Cart Capacity: 500 lbs. (Evenly distributed)
- Overall: 40" L x 17" W x 33" H
- Shipping Weight: 36.60 lbs.

### ATD-7038 Features:

- Heavy duty polypropylene material
- Molded handle with storage compartments and towel bar
- 3" deep trays
- (4) 5" heavy-duty non-marring casters (2-360° swivel)

### ATD-7038 Specifications:

- Cart Capacity: 500 lbs. (Evenly distributed)
- Overall: 46" L x 25" W x 33" H
- Shipping Weight: 50.70 lbs.

# **SAFETY INFORMATION**

## **Assembly Precautions**

---

1. Assemble only according to these instructions. Improper assembly can create hazards.
2. Wear ANSI-approved safety goggles and heavy-duty work gloves during assembly.
3. Keep assembly area clean and well lit.
4. Keep bystanders out of the area during assembly.
5. Do not assemble when tired or when under the influence of drugs or medication.
6. Weight capacity and other product capabilities apply to properly and completely assembled product only.

## **User Precautions**

---

1. This product is not a toy. Do not allow children to play with or near this tool cart.
2. Use as intended only.
3. Inspect before every use; do not use if parts are loose, damaged or missing.
4. Do not exceed listed weight capacity, evenly distributed. Be aware of dynamic loading. Sudden load movement may briefly create excess load causing product failure.
5. Use only on flat, level, hard surface able to properly support cart and load.
6. Maintain product labels and nameplates. These carry important safety information. If unreadable or missing, contact your ATD Tools distributor for replacements.

## **Assembly Instructions**

**Note:** Use a rubber mallet to ensure snug connection of all non-metal parts. Refer to the parts breakdown on the following page for item number references.

1. Place the bases of the four legs (5 & 6) into the corners of the lower tray (2). The flange on each post will only fit into specific corners.
2. Insert carriage bolts (10) down through the holes in the bases of the posts (5 & 6).
3. Attach casters (8 & 9) with carriage bolts (10) using split washers (11) and nuts (12). For best operation, the two straight casters (9) go on the one end of the cart, and the two swivel casters (8) go on the other end.
4. Place the upper tray (1) upside down on your work surface. Turn the handle (3) upside down with the cup holder faced toward the tray and the hand holes on the outside.
5. Place the tray with the handle assembly firmly on top of the legs (5 & 6). Position the handle above either the swivel or fixed casters, depending on operating preference.
6. Use three screws (7) through each leg (5 & 6) from underneath to secure them.



# ATD-7037

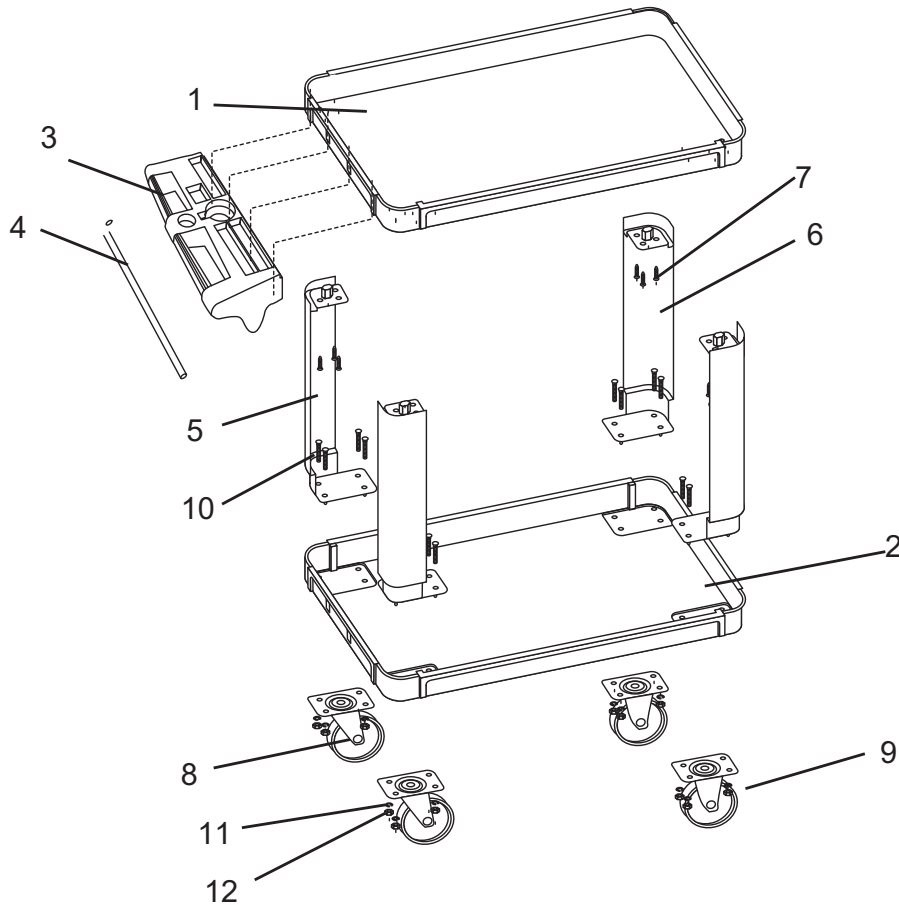

ITEM#	ORDERING PART#	PART DESCRIPTION	QTY
1	PRT7037-01	UPPER TRAY	1
2	PRT7037-02	LOWER TRAY	1
3	PRT7037-03	HANDLE	1
4	PRT7037-04	ROD	1
5	PRT7037-05	LEG (LEFT)	2
6	PRT7037-06	LEG (RIGHT)	2
7	PRT7037-HK	SCREW	12
8	PRT7037-08	SWIVEL CASTER	2
9	PRT7037-09	FIXED CASTER	2
10	PRT7037-HK	BOLT	16
11	PRT7037-HK	WASHER	16
12	PRT7037-HK	NUT	16



# ATD-7038

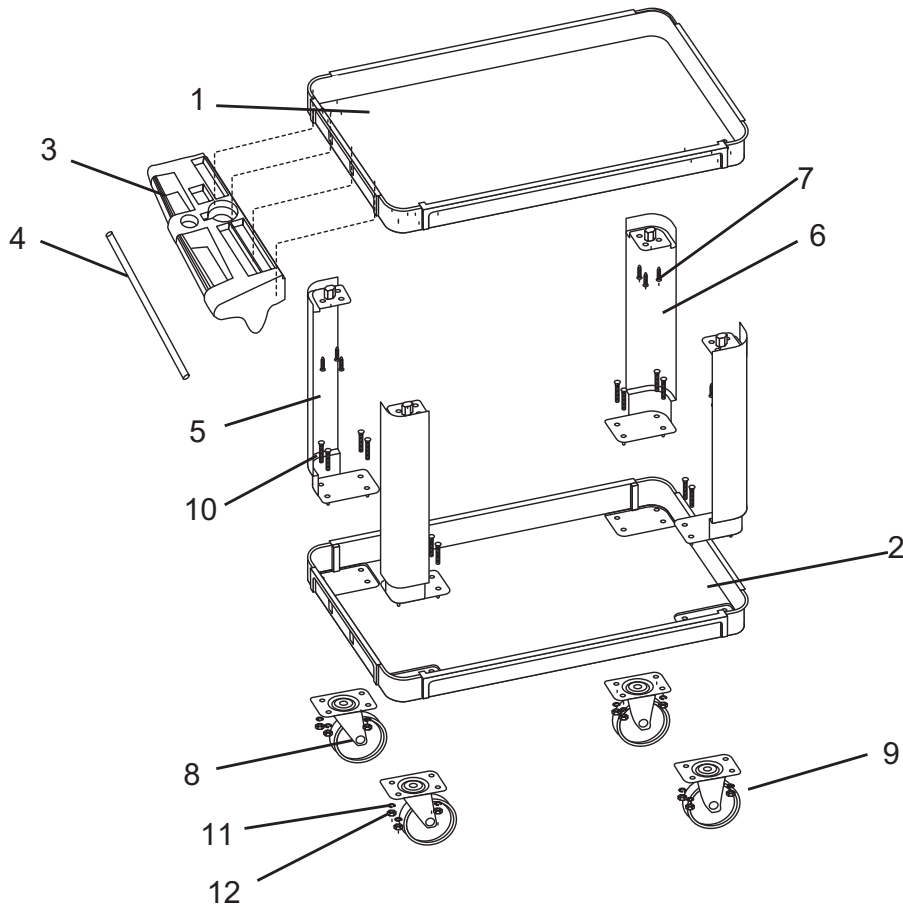

ITEM#	ORDERING PART#	PART DESCRIPTION	QTY
1	PRT7038-01	UPPER TRAY	1
2	PRT7038-02	LOWER TRAY	1
3	PRT7038-03	HANDLE	1
4	PRT7037-04	ROD	1
5	PRT7037-05	LEG (LEFT)	2
6	PRT7037-06	LEG (RIGHT)	2
7	PRT7037-HK	SCREW	12
8	PRT7037-08	SWIVEL CASTER	2
9	PRT7037-09	FIXED CASTER	2
10	PRT7037-HK	BOLT	16
11	PRT7037-HK	WASHER	16
12	PRT7037-HK	NUT	16



THIS WARRANTY AND CONFIRMED RECEIPT(S) SHOULD BE RETAINED BY THE CUSTOMER AT ALL TIMES

PURCHASED FROM: \_\_\_\_\_

DATE PURCHASED: \_\_\_\_\_

INVOICE/RECEIPT NUMBER: \_\_\_\_\_

Your ATD-7037 or ATD-7038 is warranted for a period of 12 months from the original purchase date.

For a period of one (1) year from your purchase date, ATD Tools, Inc. will repair or replace (at its option) without charge, your ATD product if it was purchased new and the product has failed due to a defect in material or workmanship which you experienced during normal use of the product. This limited warranty is your exclusive remedy.

To access the benefits of this warranty, contact your supplier, or point of sale directly. You may be advised to return the product under warranty, freight prepaid, to your supplier for warranty determination.

If this ATD product is altered, abused, misused, modified, or undergoes service by an unauthorized technician, your warranty will be void. We are not responsible for damage to ornamental designs you place on this ATD product and such ornamentation should not cover any warnings or instructions or they may void the warranty. This warranty does not cover scratches, superficial dents, and other abrasions to the paint finish that occur under normal use. It also does not cover normal wear items such as but not limited to brushes, batteries, drill bits, drill chucks, pads or blades.

Subject to the law in your state:

- (1) Your sole and exclusive remedy is repair or replacement of the defective product as described above.
- (2) ATD is not liable for any incidental damages, including but not limited to, lost profits and unforeseeable consequences.
- (3) The repair and replacement of this product under the express limited warranty described above is your exclusive remedy and is provided in lieu of all other warranties, express or implied. All other warranties, including implied warranties and warranties of merchantability or fitness for a particular purpose are disclaimed and, if disclaimer is prohibited, these warranties are limited to one year from your date of purchase of this product.

Some states' laws do not allow limited durations on certain implied warranties and some states' laws do not allow limitations on incidental or consequential damages. You should consult the law in your state to determine how your rights may vary.

[Affix receipt or invoice here for safe keeping]