



ATD-6580 Pickup Truck Bed Lifter Owner's Manual



Features:

- Allows one person to lift truck bed using an engine hoist
- Adjustable bracket design to accommodate various bed sizes
- Lifter bracket adjusts quickly and easily to evenly distribute the bed weight
- Support pad dimensions: 6.3" L x 1.5" W x 9" H
- Powder coated steel frame

Specifications:

- Maximum load capacity 600 lbs.
- Adjusts from 40" to 69"
- Shipping weight: 42 lbs.

SAFETY INFORMATION

Assembly Precautions

1. Assemble only according to these instructions. Improper assembly can create hazards.
2. Wear ANSI-approved safety goggles and heavy-duty work gloves during assembly.
3. Keep assembly area clean and well lit.
4. Keep bystanders out of the area during assembly.
5. Do not assemble or use this device when tired or when under the influence of drugs or medication.
6. Weight capacity and other product capabilities apply to properly and completely assembled product only.

User Precautions

1. This Pickup Truck Bed Lifter is not a toy. Do not allow children to play with or near this Pickup Truck Bed Lifter.
2. Use as intended only.
3. Inspect before every use; do not use if parts are loose, damaged or missing.
4. Do not exceed listed weight capacity, evenly distributed. Be aware of dynamic loading. Sudden load movement may briefly create excess load causing product failure.
5. Use only on flat, level, hard surface able to properly support the truck bed and it's load.

ASSEMBLY INSTRUCTIONS

NOTE: Leave ALL nuts and bolts hand tight until everything is together, and aligned.

• Refer to page 3 & 4 of this manual for more details.

- 1) Slide the Sliding Hook (#4) over the Center Frame Support (#3), as shown in figure 1. Make note of the bolt hole configuration. Tighten the Hand Knob (#5) hand tight to prevent it from sliding while you complete the assembly, as shown in figure 2.
- 2) Slide the Center Frame Support with Sliding Hook (#4), into the outer frame support as shown in figure 3. Secure with bolt (#7), washer (#8) and lock nut (#9) as shown in figure 4. Repeat for the other end of the Center Frame Support with Sliding Hook.
- 3) Insert Support Arm (#1) into square holes on the ends of the outer frame supports (#2) as shown in figure 5, and secure with the Hand Knobs (#5) as shown in figure 6.

Your ATD-6580 Pickup Truck Bed Lifter is now ready for use.

OPERATING INSTRUCTIONS

NOTE: The Pickup Bed Lifter is recommended for use with an engine hoist or overhead electric hoist.

Ensure that your crane, winch, or other lifting device is rated for your load.

- 1) After removing all bed bolts, fuel neck bolts and any other accessories and connectors (check your shop manual for disassembly instructions for your particular vehicle), place your Pickup Truck Bed Lifter into the bed of the truck and extend the Support Arms (#1) to reach under the lip of the pickup bed and center the load and secure the Support Arms (#1) with the Hand Knobs (#5).
- 2) The load can be adjusted by moving the Sliding Hook to accommodate the load, or by adding a counterweight to the bed itself to help balance the load.
NOTE: Be sure to secure the Sliding Hook (#4) with the Hand Knob (#5) after adjustment, to avoid unexpected sliding of your load.
- 3) Use your lifting device to lift the bed off of your truck's frame.

Figure 1

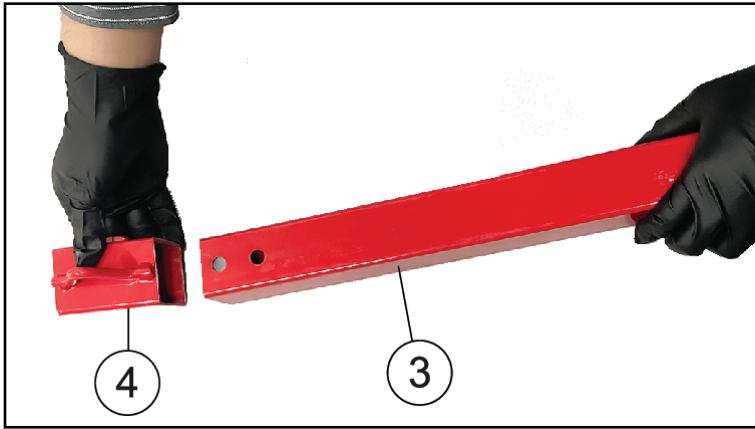

Figure 2

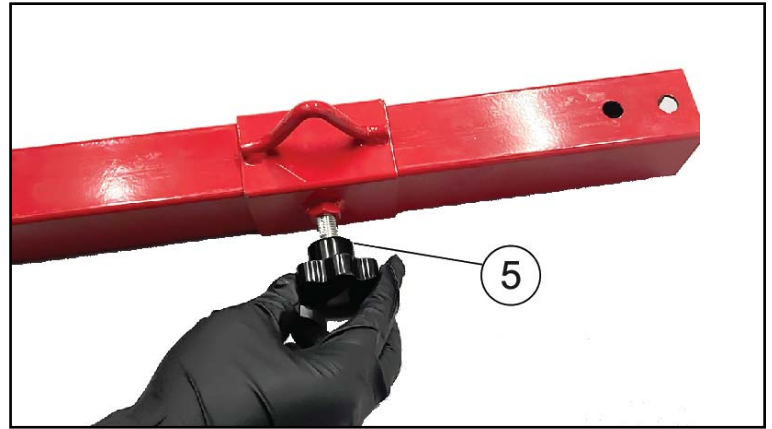

Figure 3

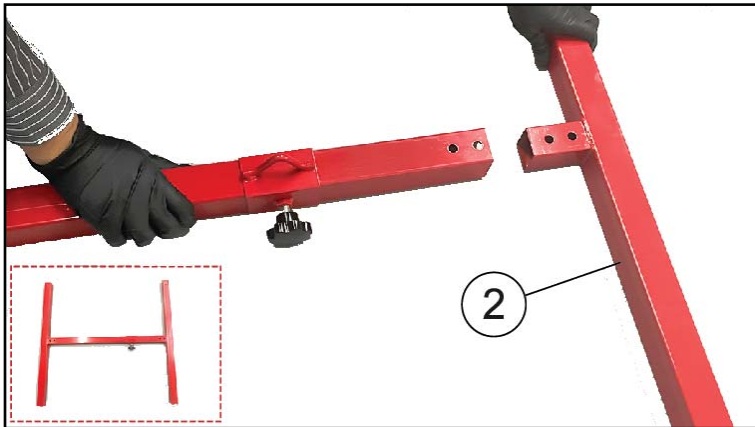

Figure 4

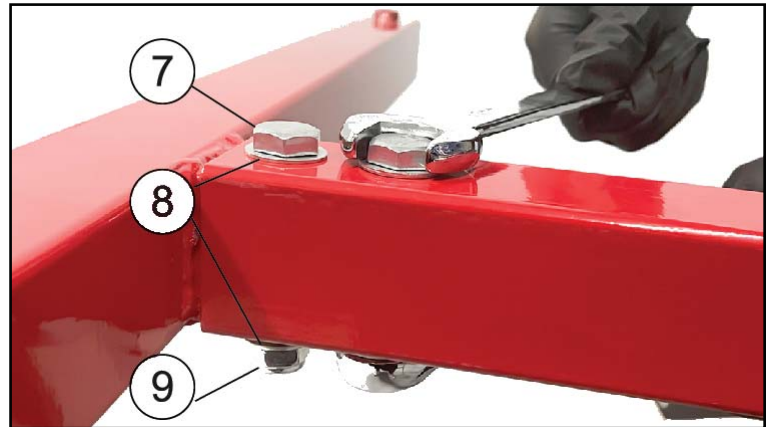

Figure 5

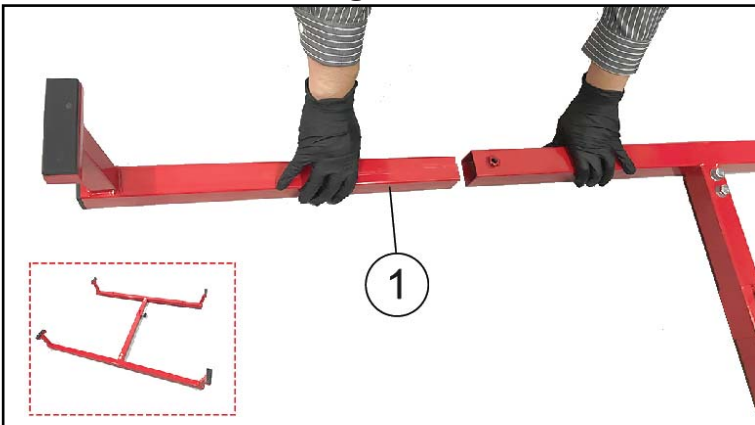
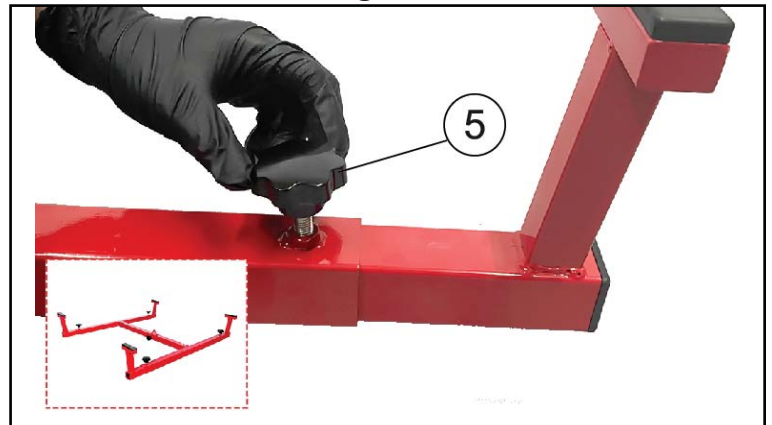
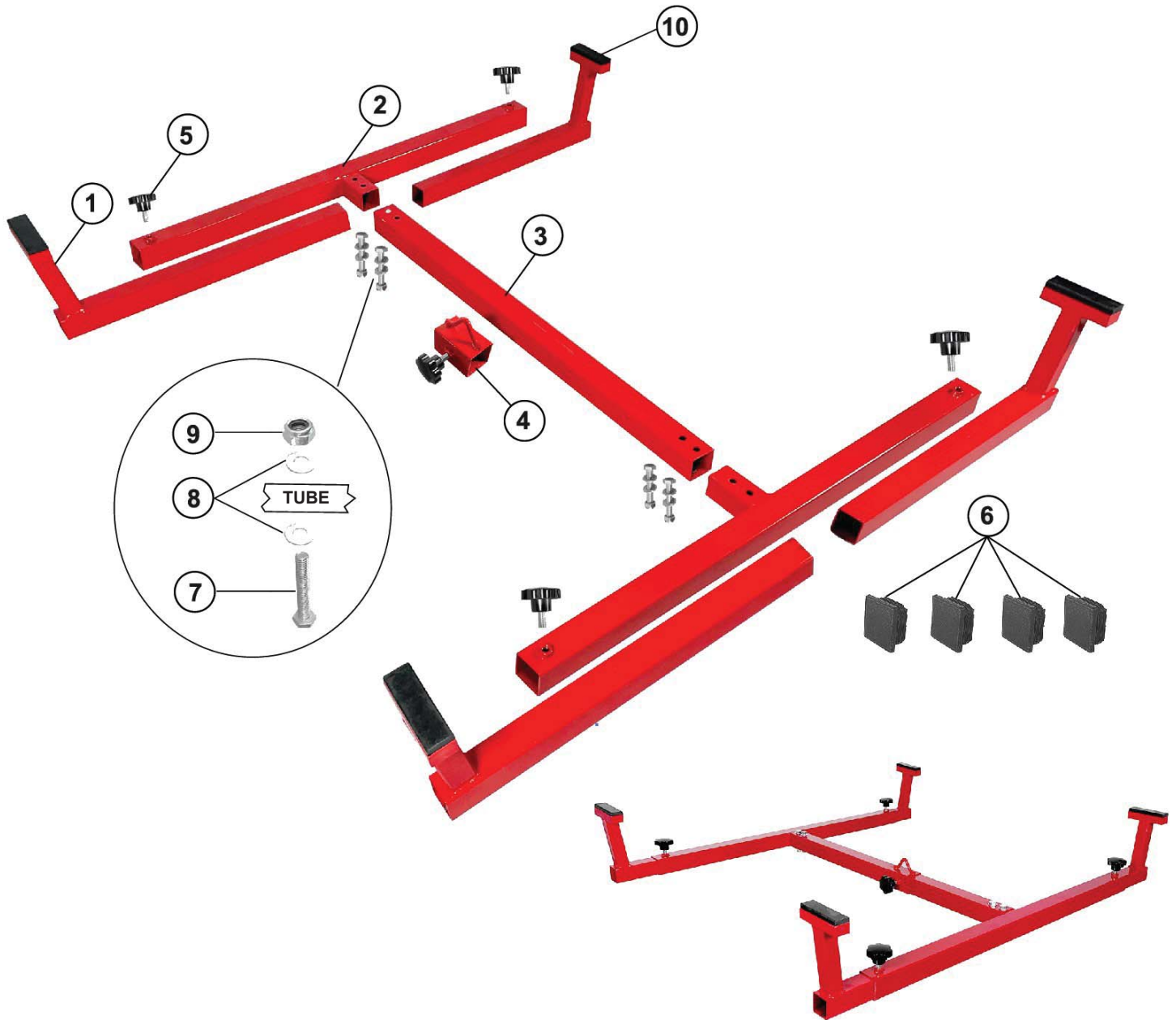

Figure 6



REPLACEMENT PARTS

Not all components of this product are replacement items, but are illustrated as a convenient reference for position in the assembly sequence. When ordering parts, give model number, part number and description. Call your distributor for current pricing:



ITEM#	ORDERING PART#	PART DESCRIPTION	QTY
1	PRT6580-01	SUPPORT ARM	4
2	PRT6580-02	OUTER FRAME SUPPORT	2
3	PRT6580-03	CENTER FRAME SUPPORT	1
4	PRT6580-04	SLIDING HOOK	1
5	PRT6580-05	HAND KNOB	5
6	PRT6580-06	PLASTIC END CAP	4
7	PRT6580-HK	BOLT, M10 x 60	4
8	PRT6580-HK	WASHER, M10	8
9	PRT6580-HK	LOCKING NUT, M10	4
10	PRT6580-10	NON-SLIP PAD	4



THIS WARRANTY AND CONFIRMED RECEIPT(S) SHOULD BE RETAINED BY THE CUSTOMER AT ALL TIMES

PURCHASED FROM: _____

DATE PURCHASED: _____

INVOICE/RECEIPT NUMBER: _____

Your ATD-6580 is warranted for a period of 12 months from the original purchase date.

For a period of one (1) year from your purchase date, ATD Tools, Inc. will repair or replace (at its option) without charge, your ATD product if it was purchased new and the product has failed due to a defect in material or workmanship which you experienced during normal use of the product. This limited warranty is your exclusive remedy.

To access the benefits of this warranty, contact your supplier, or point of sale directly. You may be advised to return the product under warranty, freight prepaid, to your supplier for warranty determination.

If this ATD product is altered, abused, misused, modified, or undergoes service by an unauthorized technician, your warranty will be void. We are not responsible for damage to ornamental designs you place on this ATD product and such ornamentation should not cover any warnings or instructions or they may void the warranty. This warranty does not cover scratches, superficial dents, and other abrasions to the paint finish that occur under normal use. It also does not cover normal wear items such as but not limited to brushes, batteries, drill bits, drill chucks, pads or blades.

Subject to the law in your state:

- (1) Your sole and exclusive remedy is repair or replacement of the defective product as described above.
- (2) ATD is not liable for any incidental damages, including but not limited to, lost profits and unforeseeable consequences.
- (3) The repair and replacement of this product under the express limited warranty described above is your exclusive remedy and is provided in lieu of all other warranties, express or implied. All other warranties, including implied warranties and warranties of merchantability or fitness for a particular purpose are disclaimed and, if disclaimer is prohibited, these warranties are limited to one year from your date of purchase of this product.

Some states' laws do not allow limited durations on certain implied warranties and some states' laws do not allow limitations on incidental or consequential damages. You should consult the law in your state to determine how your rights may vary.

[Affix receipt or invoice here for safe keeping]