



ATD-6574 Detailing Cart Owner's Manual



Features:

- Provides mobile storage for all detailing materials
- Allows movement of supplies to work area for increased productivity
- (4) 4" polyurethane casters (2 locking)

Specifications:

- (3) Hooks
- (3) Small baskets
- (3) Large baskets
- Dimensions: 66.5" x 36.4" x 19.6"

GENERAL SAFETY INFORMATION

- Not for use by unauthorized persons and minors
- Not to be used as a climbing frame or anchor point
- Tie back long hair and avoid wearing loose clothing when using this cart
- Use on a stable, level and dry surface
- Keep your work area clean and organized at all times

ASSEMBLY INSTRUCTIONS

*See parts list on next page for detail

- 1) Attach the cross tube #4. Using 4 bolts (#7) and 4 washers (#9). Bolt the cross tube (#4) between the 2 side frames (#3).
2. Assemble the 3 mesh shelves (#5) from bottom to top, using 14 bolts (#8), 28 washers (#9) and 14 nuts (#10). Bolt the 3 mesh shelves (#5) to the 2 side frames (#3).
NOTE: Only install the middle bolt on the top mesh shelf into the middle bolt hole at this time. Do not tighten fully at this time to allow for any adjustments once the 3 mesh shelves (#5) are fully assembled.
3. Bolt 4 casters (#11) to each bottom corner of the cart at this time. Fully tighten them to ensure stability while you complete the assembly.
4. Using 4 bolts (#6), 8 washers (#9) and 4 nuts (#10), bolt the 2 upper mesh side frames (#2) to the top of the lower shelf assembly completed in step 3. Do not tighten fully at this time to allow for any adjustments.
5. Using 6 bolts (#6), 12 washers (#9) and 6 nuts (#10), bolt the upper back mesh frame (#1) to the 2 upper mesh side frames (#2).
6. Adjust framework to be straight and tighten all bolts and nuts at this time.
7. Hang the mesh baskets (#12 and #13) and hooks (#14) on the completed cart to suit your needs.

CLEANING / MAINTENANCE

This cart should be maintenance free. To keep it clean, use a clean damp cloth and wipe your cart down as needed. Do NOT use caustic or abrasive cleaners when cleaning this cart as doing so could harm the protective finish.

REPLACEMENT PARTS

Not all components of this rack are replacement items, but are illustrated as a convenient reference for location and position in the assembly sequence. When ordering parts, please give the model number and parts description. Call your distributor for current pricing.

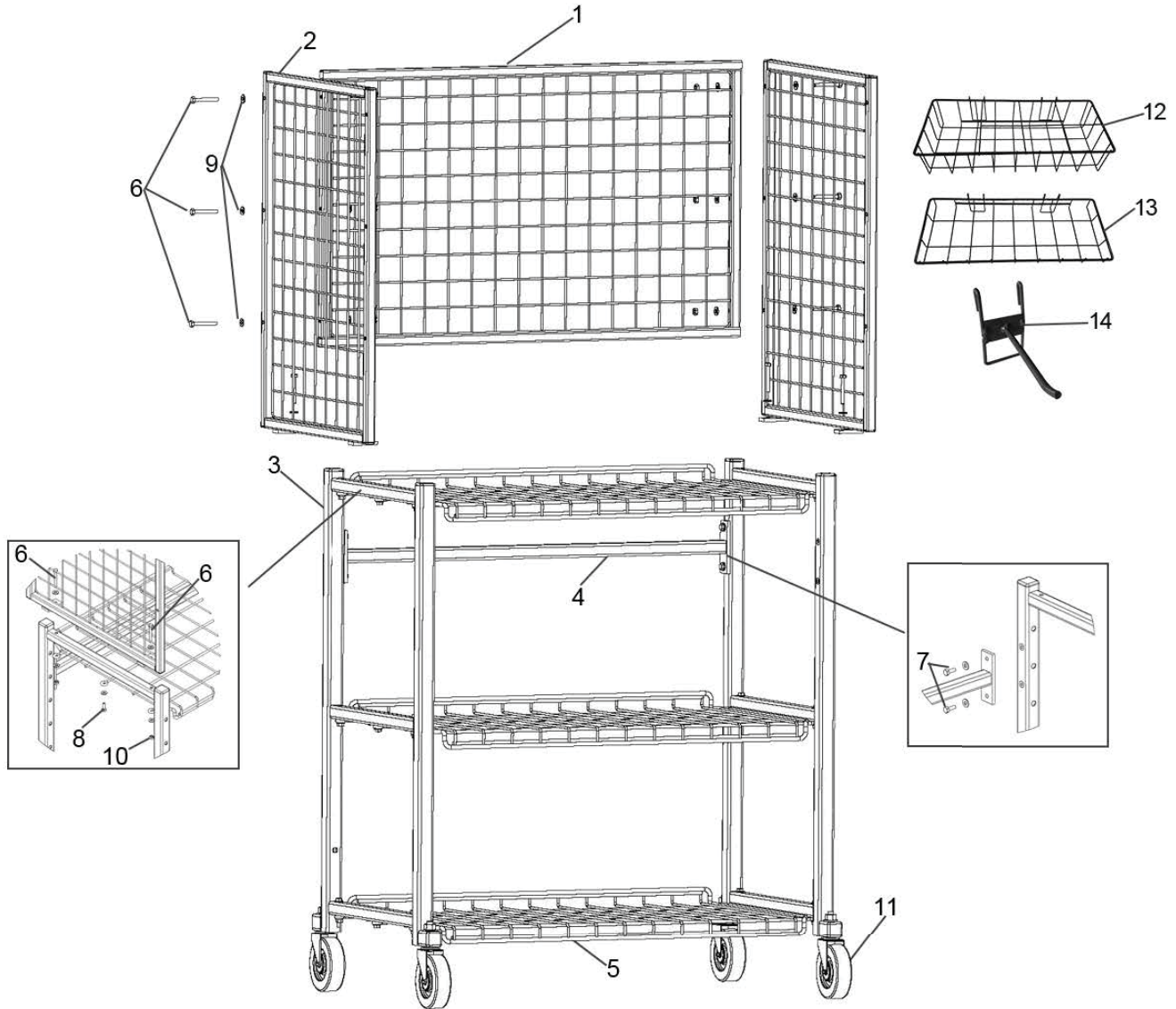

ITEM#	ORDERING PART#	PART DESCRIPTION	QTY
1	PRT6574-01	UPPER BACK MESH FRAME	1
2	PRT6574-02	UPPER SIDE MESH FRAME	2
3	PRT6574-03	SIDE FRAME	2
4	PRT6574-04	CROSS TUBE	1
5	PRT6574-05	MESH SHELF	3
6	PRT6574-HK	BOLT (M6 x 50)	10
7	PRT6574-HK	BOLT (M6 x 20)	4

ITEM#	ORDERING PART#	PART DESCRIPTION	QTY
8	PRT6574-HK	BOLT (M6 x 40)	14
9	PRT6574-HK	WASHER (M6)	52
10	PRT6574-HK	NUT (M6)	24
11	PRT6574-11	CASTER SET	4
12	PRT6574-12	BIG MESH BASKET	3
13	PRT6574-13	SMALL MESH BASKET	3
14	PRT6574-14	HOOK	4

PRT6574-HK - Hardware kit includes #6, #7, #8, #9 & #10



ATD[®]

WARRANTY

1 YEAR LIMITED WARRANTY

THIS WARRANTY AND CONFIRMED RECEIPT(S) SHOULD BE RETAINED BY THE CUSTOMER AT ALL TIMES

PURCHASED FROM: _____

DATE PURCHASED: _____

INVOICE/RECEIPT NUMBER: _____

Your ATD-6574 is warranted for a period of 12 months from the original purchase date.

For a period of one (1) year from your purchase date, ATD Tools, Inc. will repair or replace (at its option) without charge, your ATD product if it was purchased new and the product has failed due to a defect in material or workmanship which you experienced during normal use of the product. This limited warranty is your exclusive remedy.

To access the benefits of this warranty, contact your supplier, or point of sale directly. You may be advised to return the product under warranty, freight prepaid, to your supplier for warranty determination.

If this ATD product is altered, abused, misused, modified, or undergoes service by an unauthorized technician, your warranty will be void. We are not responsible for damage to ornamental designs you place on this ATD product and such ornamentation should not cover any warnings or instructions or they may void the warranty. This warranty does not cover scratches, superficial dents, and other abrasions to the paint finish that occur under normal use. It also does not cover normal wear items such as but not limited to brushes, batteries, drill bits, drill chucks, pads or blades.

Subject to the law in your state:

- (1) Your sole and exclusive remedy is repair or replacement of the defective product as described above.
- (2) ATD is not liable for any incidental damages, including but not limited to, lost profits and unforeseeable consequences.
- (3) The repair and replacement of this product under the express limited warranty described above is your exclusive remedy and is provided in lieu of all other warranties, express or implied. All other warranties, including implied warranties and warranties of merchantability or fitness for a particular purpose are disclaimed and, if disclaimer is prohibited, these warranties are limited to one year from your date of purchase of this product.

Some states' laws do not allow limited durations on certain implied warranties and some states' laws do not allow limitations on incidental or consequential damages. You should consult the law in your state to determine how your rights may vary.

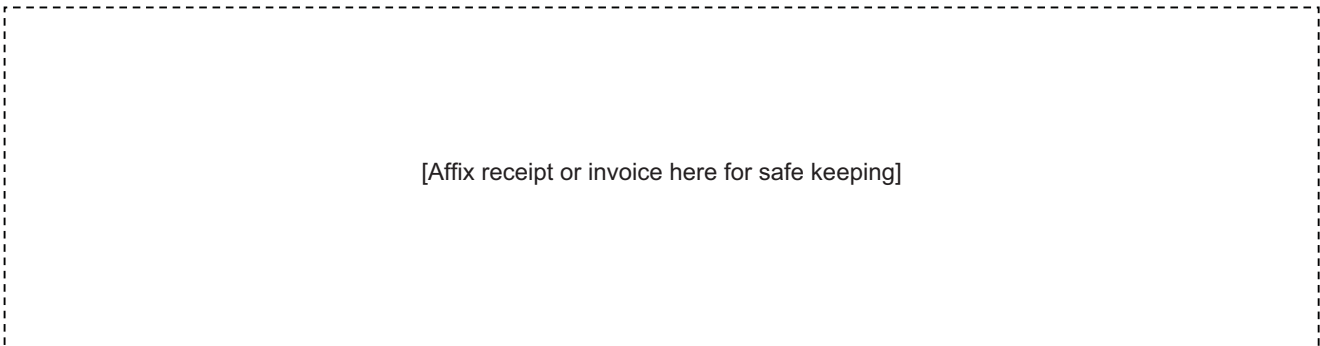

[Affix receipt or invoice here for safe keeping]