

# ATD<sup>®</sup>

## ATD-55045 3-48V Digital Circuit Tester



### Features

- Large, backlit LCD display for visible voltage readings
- Checks electrical circuits on all 3-48 Volt vehicle systems
- Impedance rating 200-4000 ohms ( $\Omega$ )
- 12 ft. coiled test lead



**WARNING**



**WARNING:** This product may contain chemicals, including lead, known to the State of California to cause cancer, birth defects or other reproductive harm. *Wash hands after handling.*

Made in China to ATD Tools, Inc. Specifications  
Visit us at [www.atdtools.com](http://www.atdtools.com)

## Safety Precautions

Caution: To help prevent personal injury

- Do not use the tool outside of the designed intent.
- Never modify the tool for any other purpose, or for its use.
- Always work in a clean, safe, well-lit, organized and adequately equipped area.
- Do not begin repairs without assurance that vehicle is in secure position, and will not move during repair.
- Keep away from children, as this tester contains sharp probes.
- This product contains chemicals, including lead, known to the state of California to cause cancer, and birth defects or other reproductive harm. Wash hands after handling.

## OPERATION:

The 2-1/4" probe screws on to the circuit tester handle as shown below.

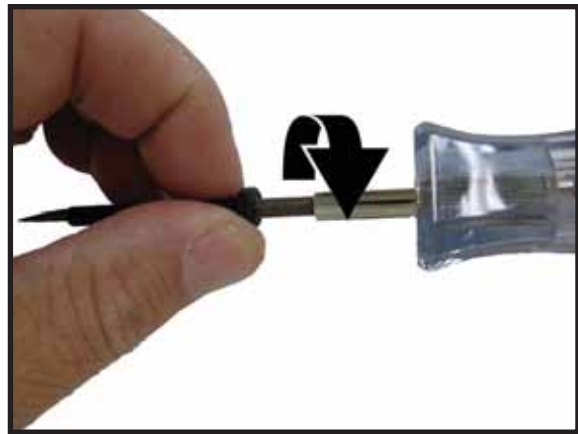

Ground the tester using the grounding clamp at the end of the circuit tester handle. Attach it securely to a metal bracket that has an electrical ground, or straight to the negative battery terminal, if it is accessible.



Using the probe end or clips, you are now ready to test your circuit. Touch your probe tip to the electrical point that is in question to get your voltage reading.



For smaller circuits where exacting precision is required, you can use a precision screwdriver or similar tool as a ground probe, connecting the ground to the end of the probe, while using the probe as the positive lead.

