



INSTRUCTIONS

Determine the size of the bearing I.D.

Choose the proper expanding driver from the table below and place the expanding driver onto the expander assembly. Make sure to line up each segment of the driver with the separation lines on the expander assembly.

Bearing Size I.D.	Driver #	Washer
1.125 to 1.475	N/A*	1-1/4"
1.475 to 1.700	1	1-1/4"
1.700 to 1.925	2	1-3/4"
1.925 to 2.150	3	1-3/4"
2.150 to 2.375	4	1-3/4"
2.375 to 2.690	5	1-3/4"
*Use the expander assembly with no driver attachment		

Assemble the Driving Bar and Expander Assembly

Place the nylon cone over the driving bar, install the proper driving washer and then screw expander assembly into the threaded end of the driving bar.

(An extension for the driving bar is included for use when necessary.)

Bearing Removal

Insert the expander assembly into the block from the front and align with bearing. Rotate the drive handle until the expanding driver is snug in the bearing. Slide the nylon cone up against the first bearing housing and drive the bearing out. Loosen the driver assembly and pull back to the next bearing to be removed and repeat the process.

Installation

Set the tool up the same as in the removal process. Place the bearing on the expanding driver and tighten until the bearing is firmly in place insert the tool into the block. Hold the guide cone in place against the number one housing and drive in the bearing. Repeat these steps to install the other bearings. To drive the number one bearing insert the driver from the rear of the block.

ATD®

ATD-8620

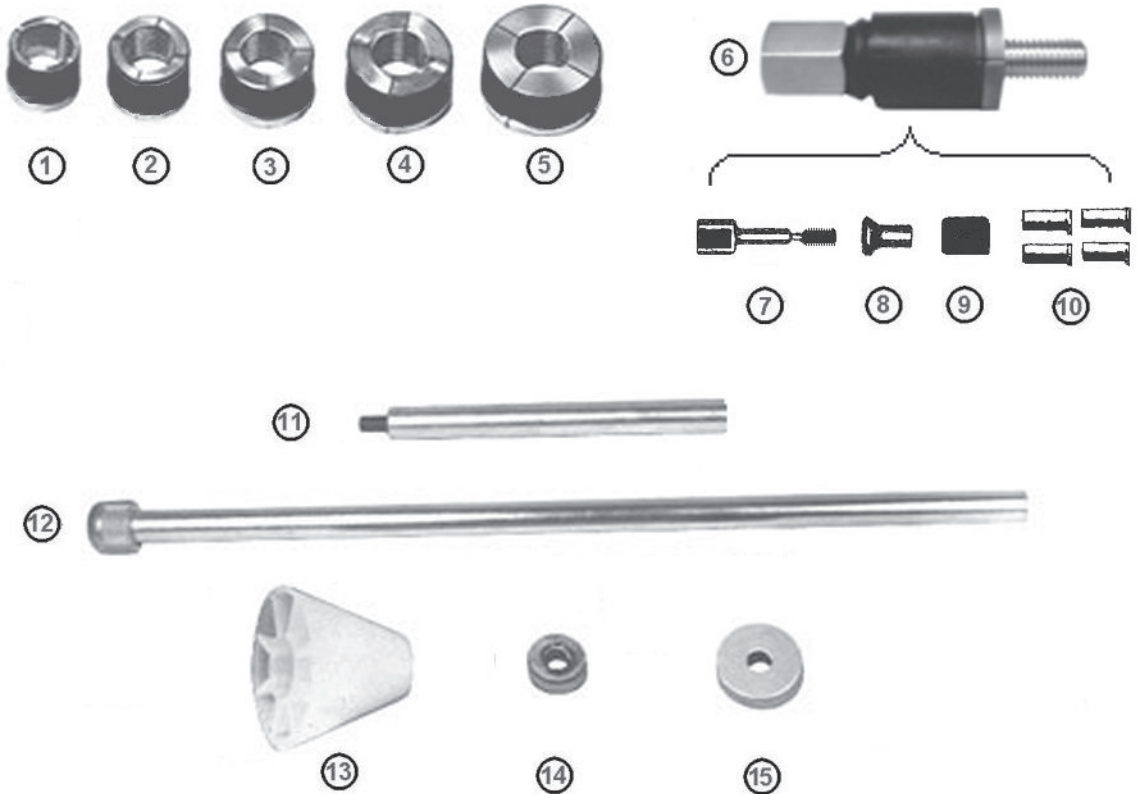

ORDERING PART#	ITEM#	PART DESCRIPTION
PRT8620-1	1	EXPANDING DRIVER RANGE 1.475-1.70
PRT8620-2	2	EXPANDING DRIVER RANGE 1.70-1.925
PRT8620-3	3	EXPANDING DRIVER RANGE 1.925-2.15
PRT8620-4	4	EXPANDING DRIVER RANGE 2.15-2.375
PRT8620-5	5	EXPANDING DRIVER RANGE 2.375-2.690
PRT8620-6	6	EXPANDER ASSY
PRT8620-7	7	EXPANDER SHAFT
*	8	EXPANDER CONE USE PRT8620-6
*	9	EXPANDER SLEEVE USE PRT8620-6
*	10	EXPANDER JAWS SET USE PRT8620-6
PRT8620-11	11	DRIVER BAR EXTENTION
PRT8620-12	12	DRIVER BAR
PRT8620-13	13	GUIDE CONE
PRT8620-14	14	DRIVING WASHER SMALL 1.1/4" DIA
PRT8620-15	15	DRIVING WASHER LARGE 1.3/4" DIA