



**ATD-7461**  
**1,500 LBS Motorcycle/ATV Jack**  
**Operating Instructions and User Cautions**



**CAUTION:** Before using this product, read this manual and follow all Safety Rules and Operational Instructions.

## Owner and/or Operator Responsibility

The owner and/or operator shall study the product instructions and retain them for future reference.

## Operation

The owner and/or operator shall have an understanding of the product, its operating characteristics, and safety operating instructions before operating the PALD (Portable Automotive Lifting Device). Safety information shall be emphasized and understood. If the operator is not fluent in English, the product and safety instructions shall be read to and discussed with the operator in the operator's native language by the purchaser/owner or his designee, making sure that the operator comprehends their contents.

## Maintenance

The PALD shall be maintained in accordance with the product instruction.

1. When jack is not in use, lifting arm should be in full down position.
2. Always keep jack clean and keep the screw and bearings well lubricated.
3. Keep moving parts clean; lubricate moving parts every 3 months.

## Inspection

(a) Visual inspection shall be made before each use of the PALD by checking for abnormal conditions, such as cracked welds, leaks, and damaged, loose, or missing parts.

(b) Other inspections shall be made per product operating instructions.

(c) Each PALD shall be inspected immediately if the device is believed to have been subjected to an abnormal load or shock. It is recommended that this inspection be made by a manufacturer's or supplier's authorized repair facility.

(d) Owners and/or operators should be aware that repair of this equipment may require specialized knowledge and facilities. It is recommended that an annual inspection of the PALD be made by a manufacturer's or supplier's authorized repair facility and that any defective parts, decals, or safety labels or signs be replaced with manufacturers or supplier's specified parts. A list of authorized repair facilities is available from the manufacturer or supplier.

## Damaged Equipment

Any PALD that appears to be damaged in any way, is found to be worn or operates abnormally **SHALL BE REMOVED FROM SERVICE UNTIL REPAIRED**. It is recommended that necessary repairs be made by a manufacturer's or supplier's authorized repair facility if repairs are permitted by the manufacturer or supplier.

## Alterations

Because of potential hazards associated with this type of equipment, no alterations shall be made to the product.

## Attachments and Adaptors

Only attachments and/or adaptors supplied by the manufacturer shall be used.



### Safety Markings

- (a) Study, understand, and follow all instructions before operating this device.
- (b) Do not exceed rated capacity.
- (c) Use only on hard, level surfaces.
- (d) Center load on lift platform.
- (e) Lift only those areas of the automotive vehicle specified by its manufacturer.
- (f) Immediately after lifting load, ensure lift mechanical load holding means is engaged.
- (g) Before moving, lower the load to the lowest possible point.
- (h) Secure load with appropriate restraint device.
- (i) Failure to heed these markings may result in personal injury and /or property damage.

### Safety Messages

- (a) Use of this product is limited to lifting, lowering, transporting and storing in the lowered position, loads consisting of a single motor vehicle whose lift points are compatible with the lift platform. Incompatibility is evident when the loaded vehicle wobbles, appears unstable, and/or does not securely engage the lift platform.
- (b) Restraining an incompatible load will not make the load secure and may cause unexpected loss of load.
- (c) Never work on, around or under a load that is not secured and stable.
- (d) Keep operator's and bystander's head, hands and feet away from lift arms when raising and lowering.
- (e) No alterations shall be made to this product.
- (f) Only attachments, restraints, or adapters supplied by the manufacturer shall be used.

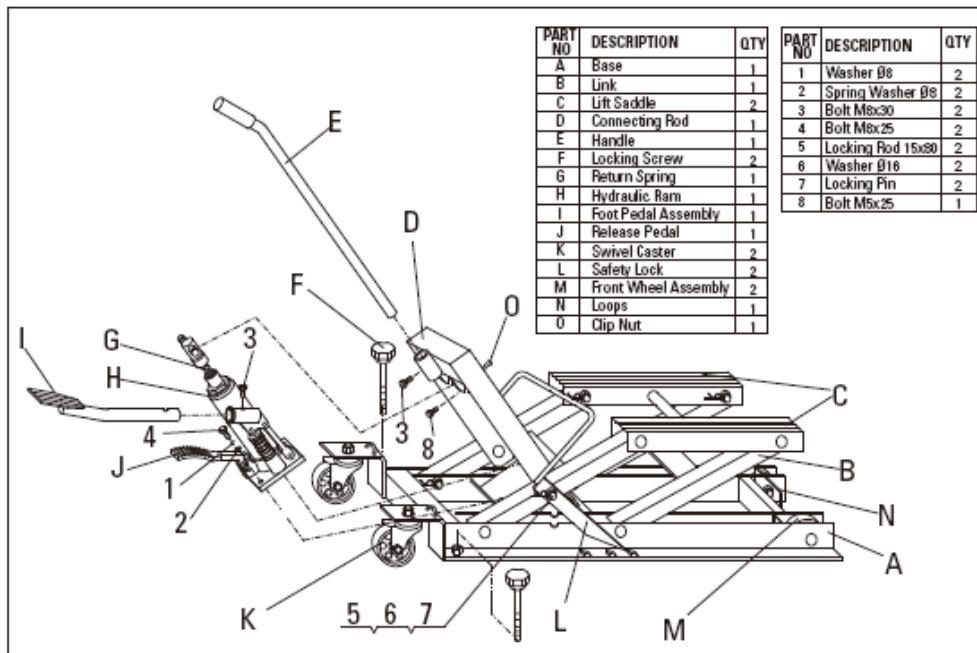

### IMPORTANT

**DO NOT OVERLOAD JACK BEYOND ITS RATED CAPACITY. NEVER MOVE THE JACK WHILE IT IS SUPPORTING LOAD.**

Sometimes during shipment and handling, air may become trapped in the hydraulic system causing poor or no lifting.

## ASSEMBLY INSTRUCTIONS

1. Place hydraulic ram (# H ) onto the base ( #A ) using (2) M8 X 25 hex bolt ( #4 ) , (2) spring washer(#2), (2) washer (#1) ,and using bolt M5 X 25 ( #8)to fix ram to connecting rod ( #D) then tighten.
2. Insert foot pedal ( #I) to the hydraulic ram ( #H), and secure using M8 X 30 bolt ( #3).
3. Place safety lock operation rod ( #L) insert to link ( #B) using (2) washer ( #6), (2) locking pin ( #7) and locking rod ( #5).
4. Insert handle ( #E) to connecting rod ( #D) using bolt M8 X 30 ( #3).
5. Ensure that all connections are tightened

## OPERATING INSTRUCTIONS

See drawing on page 3 for location of parts.

### TO RAISE THE LOAD

1. Place jack on a hard level surface.
2. To avoid item from slipping during the raising operation. **ALWAYS** first determine the center of the weight load.
3. Place the jack under the item so that the Lift Saddle is positioned under the center of the weight load.
4. Pump the foot pedal until the lift saddle comes in contact with the load to be lifted; proceed to lock wheel casters. Always check to be sure that the saddle and the load are positioned correctly before raising the jack.
5. Use Foot Pedal to raise load; **BE SURE** that Safety Lock is secured in one of three stated lock positions once desired height is reached.
6. Apply tie-down straps (See page 5, Securing the Load) once load has been raised to desired height. Thoroughly tighten straps.
7. Stabilize loaded jack on a hard surface for maximum balance by adjusting locking screws.

### TO LOWER THE LOAD

1. Raise the jack slightly and pull back on the Operation Rod, releasing the Safety Lock.
2. Fasten the Operation Rod to the connecting rod if you are lowering the load completely.
3. Press the Release Valve very gently to lower the Saddle and its load.

**CAUTION:** Tie Down Straps will become loose and load will be released upon lowering the load.

4. Remove the tie down straps after the load is secured.

### SECURING THE LOAD-1-in. x 15-ft. Ratchet Tie Down Straps

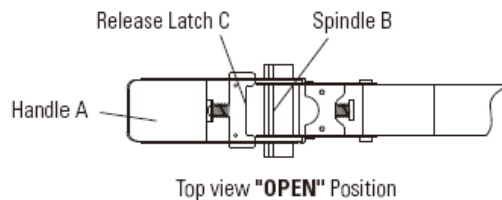

1. Connect strap hooks to loop (P) and place strap over load.
2. With the strap Handle (A) in the closed position, take long strap end and slip it through the insert slot in Spindle (B). Pull strap back over spindle.
3. Tighten the strap by ratcheting the handle back and forth until the load is secure. If necessary, take up the excess slack by hand until the strap is tight.

**CAUTION:** To avoid damage to the load, DO NOT over tighten.

4. To lock ratchet, ALWAYS leave the handle in the closed position.

#### **RELEASING THE LOAD-1-in. x 15-ft. Ratchet Tie Down Straps**

**Working limited:** 250Lbs

**Max load capacity:** 800Lbs

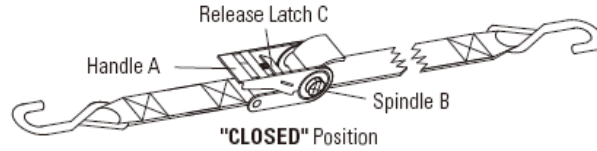

1. Hold the ratchet in one hand and with the other hand pull back on Release Latch (C) that is located on Handle (A).

2. While holding Release Latch (C) back, open Handle (A) fully past the locking gears until Latch (C) locks in a completely open position or until the load releases.

**CAUTION:** The load will release at this point.

3. To loosen or remove strap, pull up on ratchet and slide strap out of Spindle (B).



#### **FOR TIE DOWN STRAP**

1. DO NOT use tie down strap for towing vehicles or to hold or suspend human weight.

2. DO NOT use extension bar lever, pliers or any tools to operate as a handle. Use hand power only.

3. Protect strap webbing from sharp edges, heat and acid. Replace strap webbing if it is cut, worn or damaged. Inspect strap webbing, hooks and hardware before each use.

#### **MAINTENANCE**

**IMPORTANT:** Before performing any maintenance of the bottle jack ALWAYS detach from the frame and place on a level surface. **AIR PURGING INSTRUCTIONS** With the ram fully retracted, locate and remove the oil filler plug. Insert the foot pedal into the sleeve of Hydraulic Ram, and then pump 6 to 8 strokes. This will help release any pressurized air which may be trapped in the reservoir. Be sure that the oil level is just below the oil filler plug hole. Reinstall the oil filler plug. Sometimes during shipment and handling, air may become trapped in the hydraulic system causing poor or no lifting.

#### **OIL LEVEL:**

**IMPORTANT:** When adding or replacing oil, always use a good grade of hydraulic jack oil, transmission oil or turbine oil and always avoid mixing different types of oil. Never use brake fluid, alcohol, glycerine, detergent motor oil or dirty oil of any kind. Improper oil usage will cause serious internal damage to jack.

**ADDING OIL:** With ram fully lowered and jack on level ground, remove oil fill plug. Add oil if level is more than 1/4" below hole replace cover plate.

**REPLACING OIL:** For best performance and longest life, oil should be replaced at least once every year. To drain oil, remove cover plate, oil filler plug and release valve. Be VERY CAREFUL to not allow dirt or any foreign matter into the system.

**LUBRICATION:** Put grease in fitting on base and lubricate lifting arm spindle with oil, every 3 months.

**RUST PREVENTION:** Clean and wipe with an oily cloth, the piston ram and pump piston every 3 months or when signs of rust or corrosion appear. When not in use, always leave the saddle and pump piston in the completely down position.

## TROUBLE SHOOTING CHECK LIST

<b>TROUBLE</b>	<b>CAUSE</b>	<b>REMEDY</b>
Jack will not lower completely	<ol style="list-style-type: none"> <li>1. Air in hydraulic system</li> <li>2. Release valve stuck</li> </ol>	<ol style="list-style-type: none"> <li>1. Purge air from hydraulic system</li> <li>2. Transfer weight load and clean valve</li> </ol>
Jack will not hold weight	Release valve in open position	Close release valve tightly
Jack will not lift to full height	<ol style="list-style-type: none"> <li>1. Oil level low</li> <li>2. Air in hydraulic system</li> </ol>	<ol style="list-style-type: none"> <li>1. Fill to recommended level</li> <li>2. Purge air from hydraulic system</li> </ol>
Weak lifting	<ol style="list-style-type: none"> <li>1. Air in hydraulic system</li> <li>2. Dirty oil</li> <li>3. Release valve not completely closed</li> </ol>	<ol style="list-style-type: none"> <li>1. Purge air from hydraulic system</li> <li>2. Change oil. Use SAE 5W</li> <li>3. Close release valve tightly</li> </ol>
Jack will not lift load	<ol style="list-style-type: none"> <li>1. Excessive weight</li> <li>2. Release valve in open position</li> <li>3. Oil level low</li> </ol>	<ol style="list-style-type: none"> <li>1. Decrease weight or change to higher capacity jack</li> <li>2. Turn valve clockwise and tighten</li> <li>3. Fill to recommended level</li> </ol>

## One Year Warranty

Every ATD Tools product is inspected before leaving the factory. This product is warranted to be free of defects in material and workmanship. ATD Tools elects to replace free of charge or supply parts for repair, with the same or like item of equal value any item found to have defects in materials or workmanship during the first 1 year of customer ownership with proof of purchase. Proof of purchase must be either original or clear copy of your store receipt. Simply return item to the point of sale for replacement or replacement parts. This warranty gives you specific legal rights and you may also have other rights which may vary from state to state. ATD Tools, ATD Tools Emblem and the ATD Tools related graphics are ATD Tools Inc. Trademarks and are used under license. Made in China.

### For out of warranty Repair Or Replacement Parts:

Please call toll free 1-800-592-8665, Monday through Friday between the hours of 8:00 AM to 8:00 PM (Eastern Standard Time). Replacement Parts request can also be submitted via the web , 24 hours daily at [www.americancustomerservice.com](http://www.americancustomerservice.com). In all correspondence, please include model #, part #, part description and quantity required. Name, Shipping Address and Day Time Telephone number, including area code, are required to process your parts shipment request.



# ATD-7461

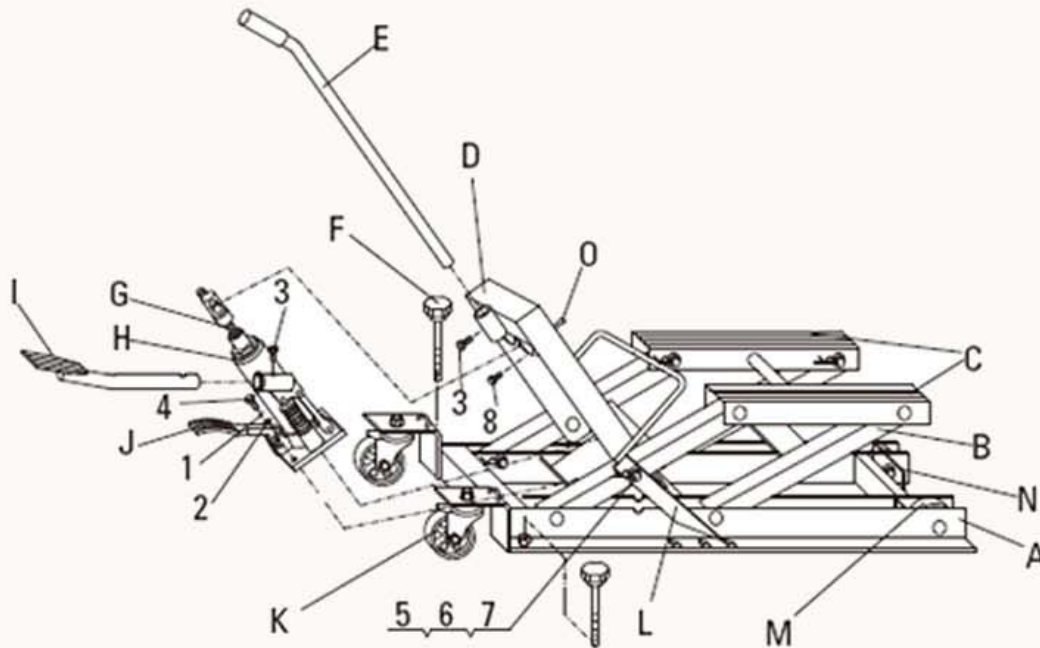

ITEM#	ORDERING PART#	PART DESCRIPTION
A	PRT7461-01	BASE
B	PRT7461-02	ROD
C	PRT7461-03	LIFT SADDLE
D	PRT7461-04	CONNECTING ROD
E	PRT7461-05	HANDLE
F	PRT7461-06	LOCKING SCREW
G	PRT7461-07	RETURN SPRING
H	PRT7461-08	HYDRAULIC RAM
I	PRT7461-09	FOOT PEDAL ASSEMBLY
J	PRT7461-10	RELEASE PEDAL
K	PRT7461-11	SWIVEL CASTER
L	PRT7461-12	SAFETY LOCK
M	PRT7461-13	FRONT WHEEL ASSEMBLY
N	PRT7461-14	LOOPS
O	PRT7461-15	CLIP NUT
1-8	PRT7461-16	HARDWARE KIT (ALL NUTS AND BOLTS)