



ATD-7020 2 SHELF SERVICE CART OWNER'S MANUAL



Features:

- 16 Ga. chrome steel frame
- Large, easy to maneuver casters
- Durable powder coated finish
- 3" Deep shelves

Specifications:

- Overall: 30-1/4" W x 16-1/2" D x 35-3/4" H
- Upper Tray: 30" W x 16" D x 3" H
- Lower Tray: 30" W x 16" D x 3" H
- Wheels: (4) 4" x 1" (2 locking)
- Capacity: 350 lbs.
- Shipping Weight: 33.4 lbs.

SERVICE CART ASSEMBLY INSTRUCTIONS:

1. Slide chrome legs (#2) into square holes cut in tray (#1) until bolt holes are aligned at top of legs.
2. Insert bolt (#6) into hole on leg and tray. Fasten nut (#10) using lock washer (#9) and flat washer (#8), but do not tighten nut completely at this time. Repeat this procedure on all four corners.
3. Repeat step 1 with second tray (#1) at bottom of legs.
4. Repeat step 2 with bottom tray (#1)
5. Insert casters (#4) into the hole of plastic insert (#5). Note: Insert the two locking casters (#3) at the same end of the cart.
6. Tighten all loose nuts and bolts.

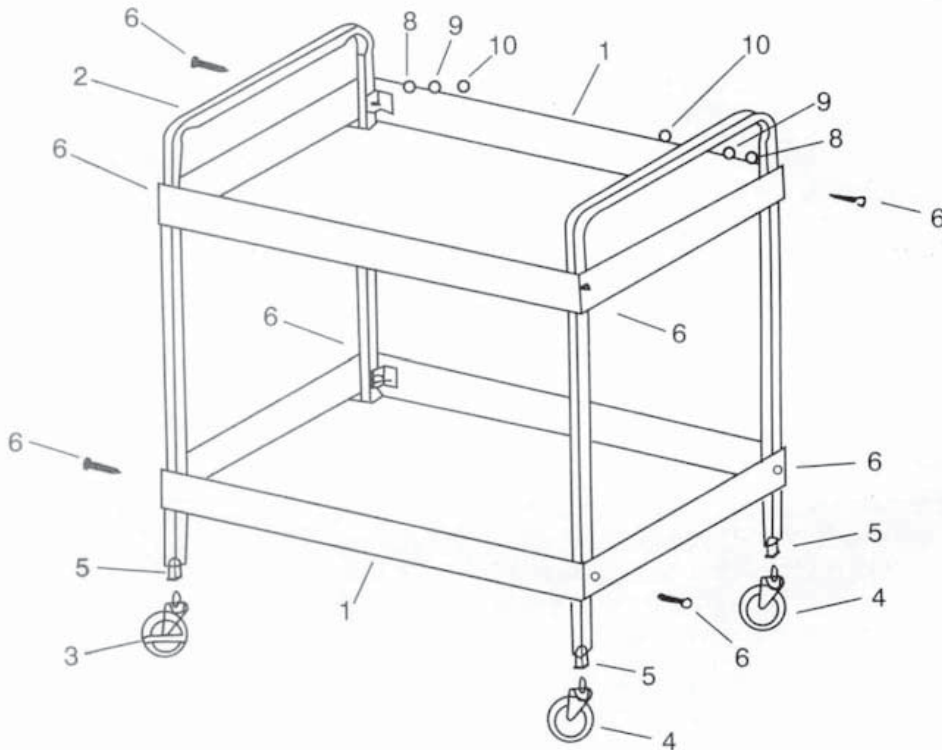

SPARE PARTS AND ACCESSORIES

| ITEM# | ORDERING PART# | PART DESCRIPTION |
|-------|----------------|-----------------------------------|
| 1 | PRT7020-01 | TRAY |
| 2 | PRT7020-02 | CHROME LEG |
| 3 | PRT7020-03 | LOCKING CASTERS |
| 4 | PRT7020-04 | NON-LOCKING CASTERS |
| 5 | PRT7020-05 | PLASTIC INSERT (SET OF 4) |
| 6 | PRT7020-06 | BOLT KIT (INCL 8EA OF #8, 9 & 10) |

Optional Accessories Also Available:

- ATD-7021 Locking Drawer
- ATD-7022 Folding Shelf
- ATD-7138 Locking Screwdriver Holder