



ATD-6563 TREE STYLE MASKING MACHINE OWNER'S MANUAL

ASSEMBLY INSTRUCTIONS

WARNING:

1. Always wear protective equipment and eyewear.
2. Cutting blades are extremely sharp; use extreme caution when assembling and when adding removing or dispensing paper and tape.
3. To avoid tipping of the unit, do not overload.

You will need an assortment of small hand tools to complete assembly of this Masking Machine.

1. Main frame assembly - Bolt axle rod assembly (14) between the vertical main frame (01) and the horizontal main frame (02) with the axle posts on the bottom side.
2. Bolt leg support assembly (03) to the end of the assembled main frame assembly from step 1.
3. Starting at the bottom hole in the main frame assembly, first bolt the tape roller (07) into the frame, then move up one hole and bolt the 22" support assembly (04) to the main frame assembly. Repeat this step for the next level up, alternating the tape roller with the 22" support assembly in the next two holes up provided in the main frame assembly.
4. Moving to the next hole up bolt a tape roller (07) into the frame, then move up one hole and bolt a 16" support assembly (05) to the main frame assembly. Repeat this step for the next level up, alternating the tape roller with the 16" support assembly in the next two holes up provided in the main frame assembly.
5. Position Wheel Assembly (06) on both sides of axle rod assembly (14) (Secure with washer, then wheel, then another washer and secure with cotter pin, as shown in FIGURE 1 below. Spread the cotter pin to secure permanently.
6. Attach the two 22" Cutting Blade Assemblies (08) to the two 22" support assemblies (04), starting at the bottom. Be sure that the cutting teeth are facing the outside of the unit and facing down. Repeat this step for the next level up. Be careful as the cutting edge is sharp.
7. Attach the two 16" cutting blade assemblies (09) to the two 16" support assemblies (05). Be sure that the cutting teeth are facing the outside of the unit and facing down. Repeat this step for the next top level. Be careful as the cutting edge is sharp.
8. Starting with the bottom level, place 2 sets of slide rings, washers, springs and washers (as shown in figure 2) along each 22" Paper Roller Assembly (10) rod. Attach the long, thin spring to the underside of the 22" cutter assembly by hooking one end of the spring onto the tab at one end and carefully stretching the spring to the other tab and securing the loop in the spring around it. Repeat this step for each paper roller and cutter assembly.
9. Place plastic caps on the ends of each support and each leg.

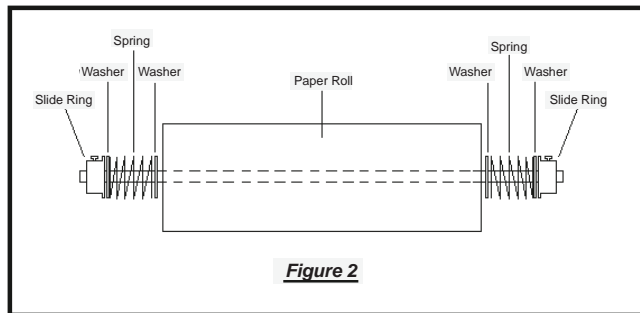
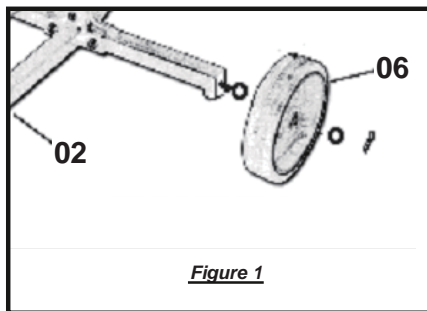

IMPORTANT: PLEASE READ THESE INSTRUCTIONS CAREFULLY. NOTE THE SAFE OPERATIONAL REQUIREMENTS, WARNINGS AND CAUTIONS. USE THIS PRODUCT CORRECTLY AND WITH CARE FOR THE PURPOSE FOR WHICH IT IS INTENDED. FAILURE TO DO SO MAY CAUSE DAMAGE AND/OR PERSONAL INJURY AND WILL INVALIDATE THE WARRANTY. PLEASE KEEP INSTRUCTIONS SAFE FOR FUTURE USE.

⚠ WARNING ⚠

WARNING: This product contains chemicals, including lead, known to the State of California to cause cancer, birth defects or other reproductive harm. Wash hands after handling.

Made in Taiwan to ATD Tools, Inc. Specifications
Visit us at www.atdtools.com

(Rev 0317)

ATD®

ATD-6563

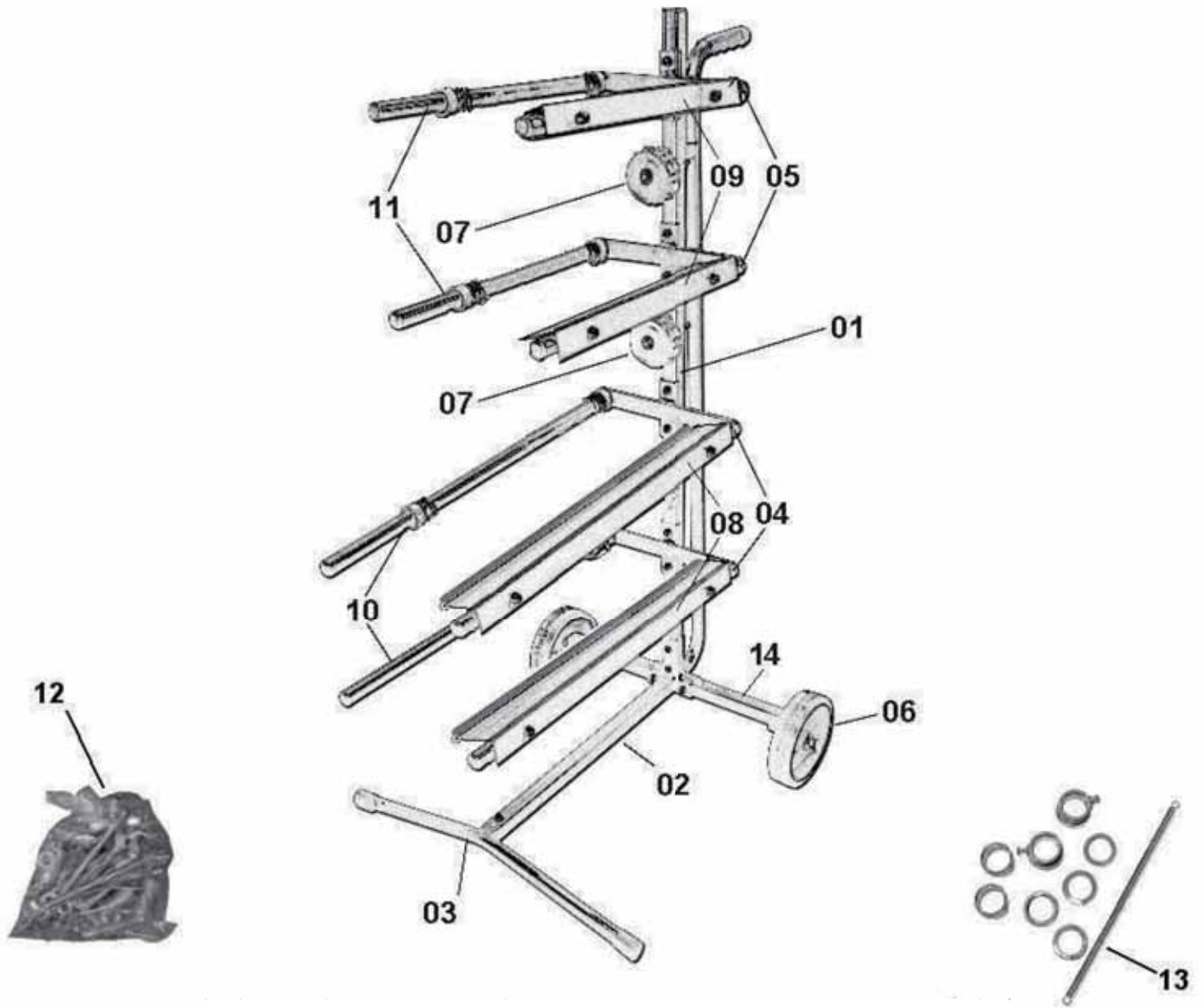

ITEM#	ORDERING PART#	PART DESCRIPTION
1	PRT6563-01	MAIN FRAME, VERTICAL
2	PRT6563-02	MAIN FRAME, HORIZONTAL
3	PRT6563-03	LEG SUPPORT
4	PRT6563-04-10	22" PAPER ROLLER
5	PRT6563-05-11	16" PAPER ROLLER
6	PRT6563-06	WHEEL ASSY
7	PRT6561-10	TAPE ROLL HOLDER (4PC)
8	PRT6563-08	22" CUTTING BLADE ASSY
9	PRT6563-09	16" CUTTING BLADE ASSY
10	PRT6563-04-10	22" PAPER ROLLER
11	PRT6563-05-11	16" PAPER ROLLER
12	PRT6563-12	HARDWARE KIT
13	PRT6563-13	SPRING KIT
14	PRT6563-14	AXLE ROD ASSY