



# ATD-5723 3 PC TAILPIPE EXPANDER SET INSTRUCTION MANUAL

## 1. SAFETY INSTRUCTIONS

- Use in a suitable, clean and tidy work area, free from unrelated materials. Ensure there is adequate lighting.
- **DO NOT** continue to attempt expanding any pipe that withstands expansion.
- **DO NOT** insert a finger into the expander at any time.
- **DO NOT** allow untrained people to use the expander.
- **DO NOT** allow children to use or play with the expander.
- **DO NOT** use the expander for tasks it is not designed to perform.
- **DO NOT** operate expander if any parts are damaged or missing as this may cause failure and/or personal injury.
- **DO NOT** operate the expander when you are tired or under the influence of alcohol, drugs or intoxicating medication.
- **DO NOT** try and expand exhaust pipes that are not already socketed and have slits cut away for expansion.
- **DO NOT** use an impact wrench or overload the tool.  
Store the expander in a safe childproof place when not in use.

## 2. INTRODUCTION & SPECIFICATIONS

Ideal for fitting aftermarket components to standard exhausts. Used to expand a length of pipe in equal proportions so the pipe is the same diameter and not tapered. Ensures a perfect fit with no leaks and also removes dents and clamp marks.

Expander Size . . . . . Small . . . . . Medium . . . . . Large  
Capacity . . . . . 1-1/8" to 1-3/4" . . . . 1-1/2" to 2-1/2" . . . . 2-1/8" to 3-1/2"  
Drive (Hex) . . . . . 43/64" . . . . . 43/64" . . . . . 3/4"



## 3. OPERATION

3.1 Insert the correct sized exhaust pipe expander into the end of the pipe (fig.1).

**NOTE!** Ensure that at least three quarters of the expander is inserted into the pipe. Failure to do so may result in damage to the expander.

3.2 Turn the hex drive clockwise to expand the tool and reshape the exhaust pipe (fig.2).

3.3 When the decided shape is made, wind the tool in the other direction to remove from the exhaust pipe.

**NOTE!** This tool is not for expanding straight pipe, only for reshaping and widening already socketed pipes.

- **DO NOT** use an impact wrench or overload the tool.

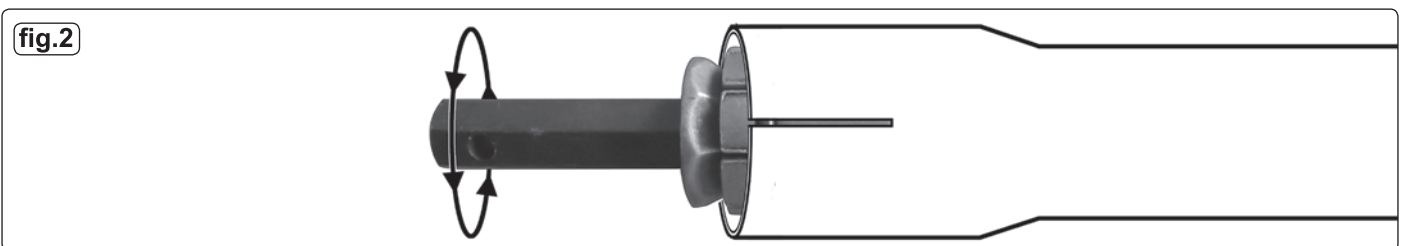
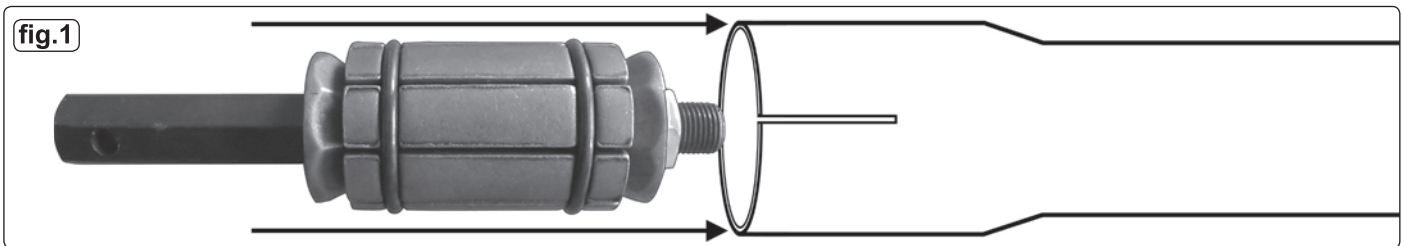

**IMPORTANT:** PLEASE READ THESE INSTRUCTIONS CAREFULLY. NOTE THE SAFE OPERATIONAL REQUIREMENTS, WARNINGS & CAUTIONS. USE THE PRODUCT CORRECTLY AND WITH CARE FOR THE PURPOSE FOR WHICH IT IS INTENDED. PLEASE KEEP INSTRUCTIONS SAFE FOR FUTURE USE.



ITEM#	ORDERING PART#	PART DESCRIPTION
1	PRT5723-01	SMALL EXPANDER 1-1/8" TO 1-3/4"
2	PRT5723-02	MEDIUM EXPANDER 1-1/2" TO 2-1/2"
3	PRT5723-03	LARGE EXPANDER 2-1/8" TO 3-1/2"
4	PRT5723-04	SMALL EXPANDER O-RING SET (2)
5	PRT5723-05	MEDIUM EXPANDER O-RING SET (2)
6	PRT5723-06	LARGE EXPANDER O-RING SET (2)